

Civic Center Townhomes

858 Civic Center Drive

Santa Clara CA

PROJECT HISTORY

Initial submittal:	02-01-2024
Formal submittal:	10-11-2024
Number of resubmittals	(7)
Date of community hearing	09-16-2025
Development review hearing	06-17-2026
Anticipated submittal of building permit	12-05-2026
Anticipated start of construction	06-01-2027

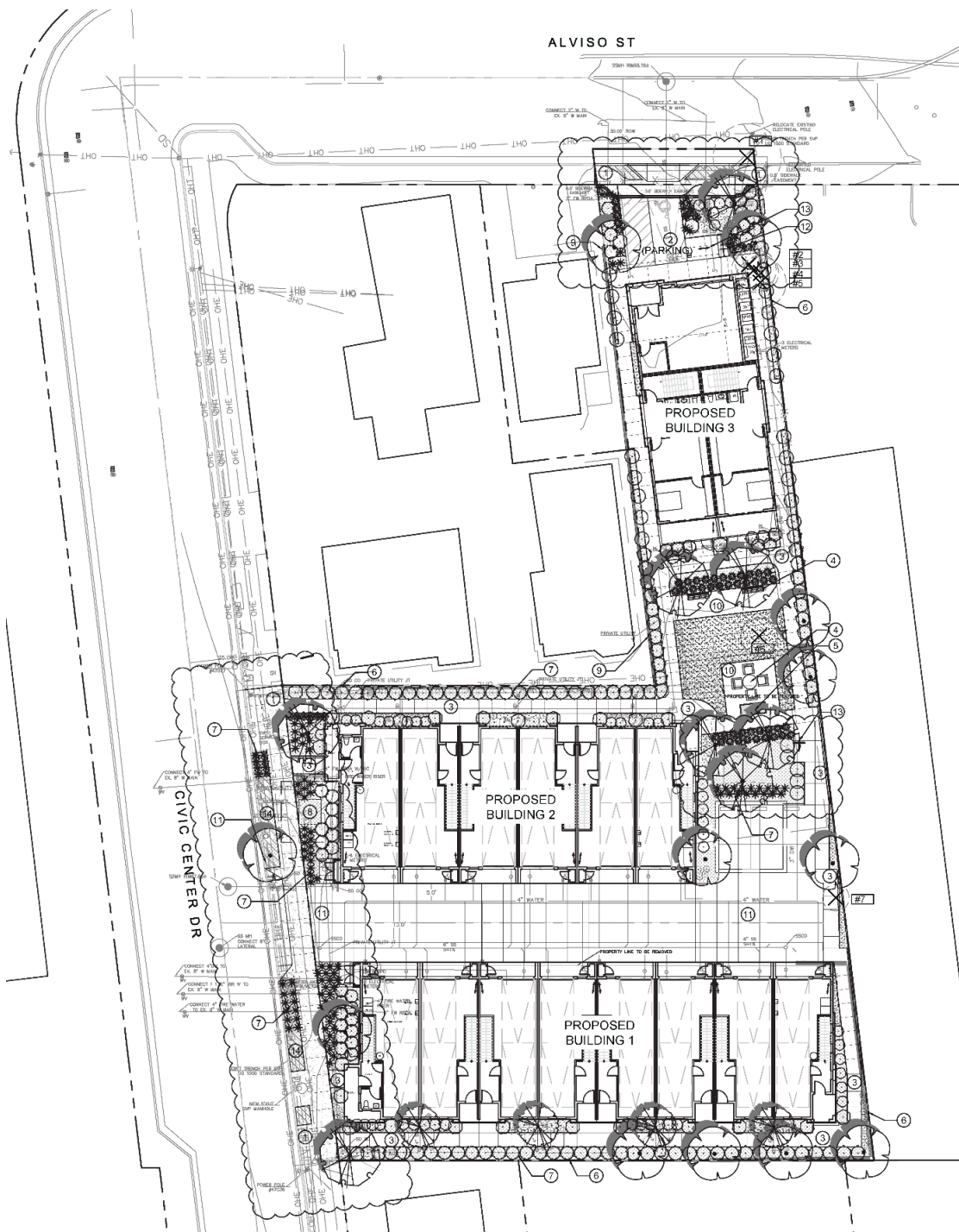

UNIT TYPE	LIVING AREA	# UNITS
Duplex Unit	2,639	2
Towhouse-End	2,100	2
Towhouse-End- Civic	2,130	2
Townhouse	2,048	10
PARKING	REQUIRED	PROVIDED
	24	32
COMMON OPEN SPACE	1600	2,326
PRIVATE OPEN SPACE	960	3,794

Site Plan and Project Parameter

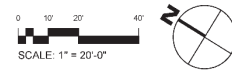



View from Aviso St



View from Civic Center Dr



View from West



View from South-East