



City of Santa Clara

Planning Commission

October 26, 2022

1041 and 1075 El Camino Real

Public Hearing Item # 1.B

PLN22-00302



1041 and 1075 El Camino Real

Request

- **Conditional Use Permit** to Allow an Outdoor Play Area for an Expanding Pre-School Facility at 1041 and 1075 El Camino Real



1041 and 1075 El Camino Real

Existing Site



1041 and 1075 El Camino Real

Use Permit

- 1,282 square foot proposed outdoor play area on an 8,280 square foot lot.
- The applicant has applied to expand an existing pre-school in order to better serve the community

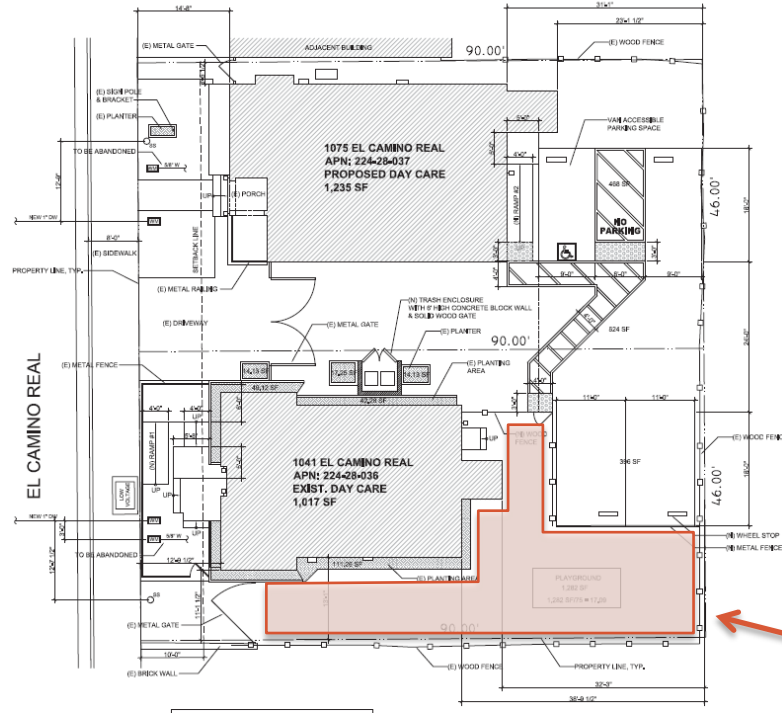

Outdoor Play Area



1041 and 1075 El Camino Real

Analysis

- Consistent with the General Plan Designation of Community Mixed Use, to encourage conveniently located childcare services
- Consistent with the zoning designation of CT – Thoroughfare Commercial, which allows childcare facilities by right and allows outdoor activities as a conditional use
- Consistent with off-street parking requirements, one space per classroom or office, the requirement for the proposed is four parking spaces, the applicant has proposed four parking spaces



1041 and 1075 El Camino Real

Recommendation

- Adopt a Resolution approving the Use Permit to allow outdoor play area for an expanding pre-school facility at 1041 and 1075 El Camino Real



City of Santa Clara

Planning Commission

June 15, 2022

1041 and 1075 El Camino Real

Public Hearing Item # 1.B

PLN22-00302