

# TEMPORARY TENT LOCATION

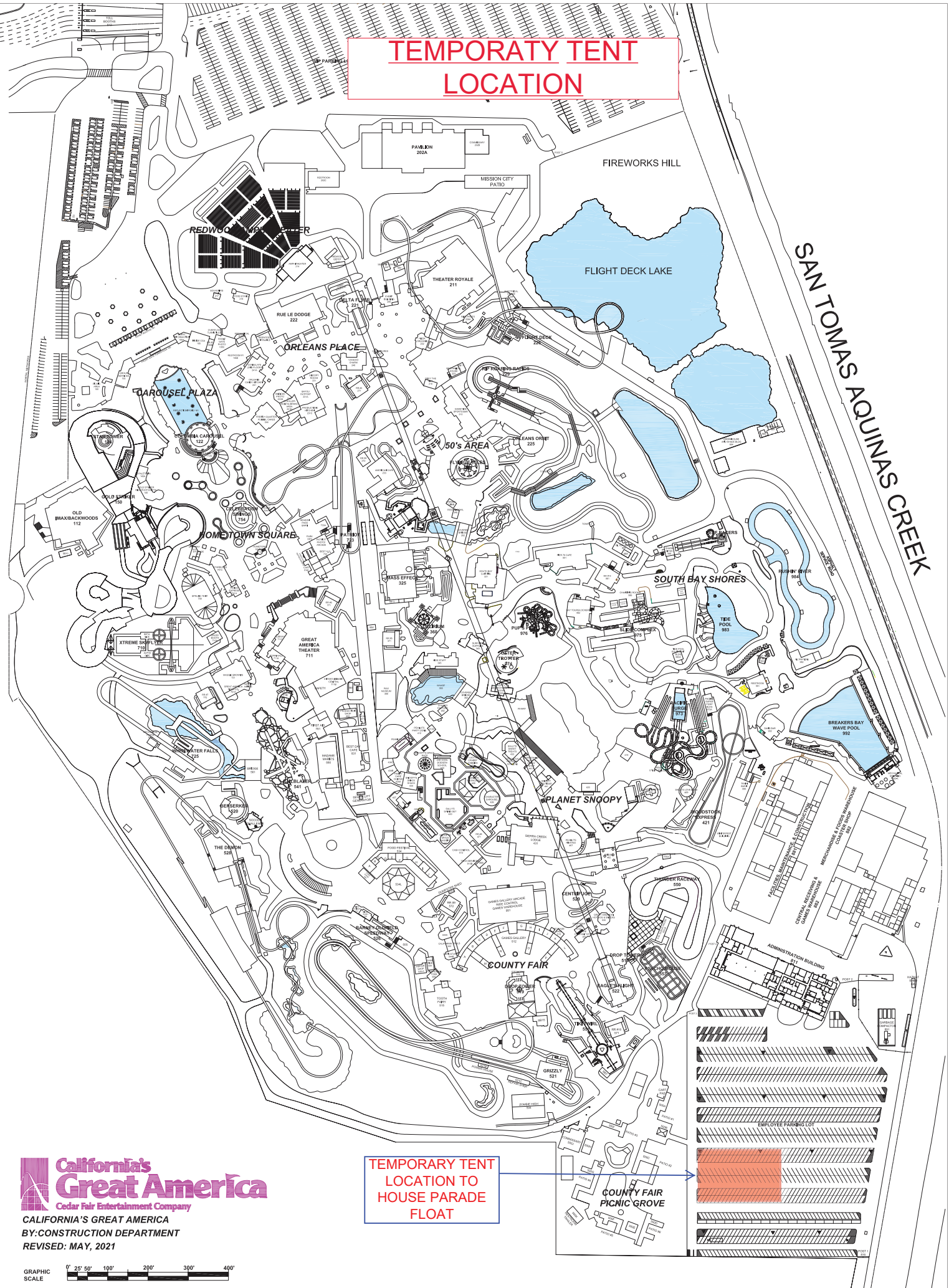

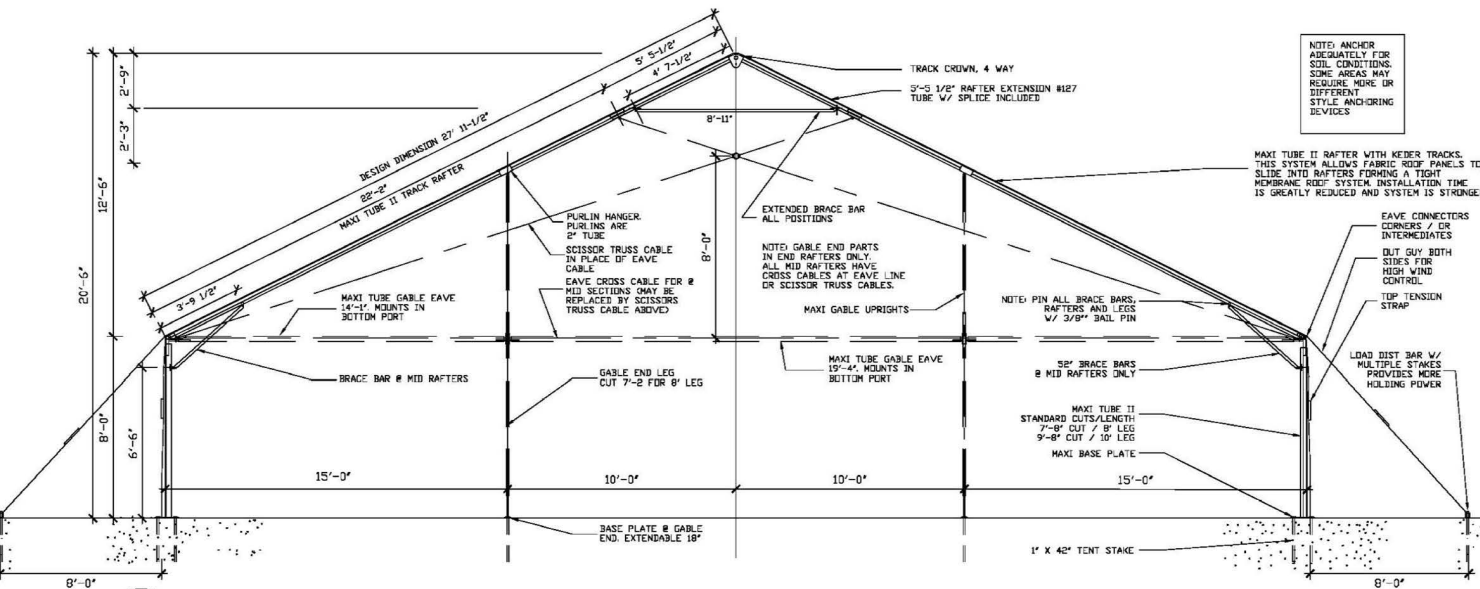

NOTE: ANCHOR  
ADEQUATELY FOR  
SOIL CONDITIONS.  
SOME AREAS MAY  
REQUIRE MORE OR  
DIFFERENT  
STYLE ANCHORING  
DEVICES

MAXI TUBE II RAFTER WITH KEGER TRACKS.  
THIS SYSTEM ALLOWS FABRIC ROOF PANELS TO  
SLIDE INTO RAFTERS FORMING A TIGHT  
MEMBRANE REEF SYSTEM. INSTALLATION TIME  
IS GREATLY REDUCED AND SYSTEM IS STRONGER.

1 CROSS SECTION - 50' FRAME GABLE END TENT  
1/4"=1'-0"

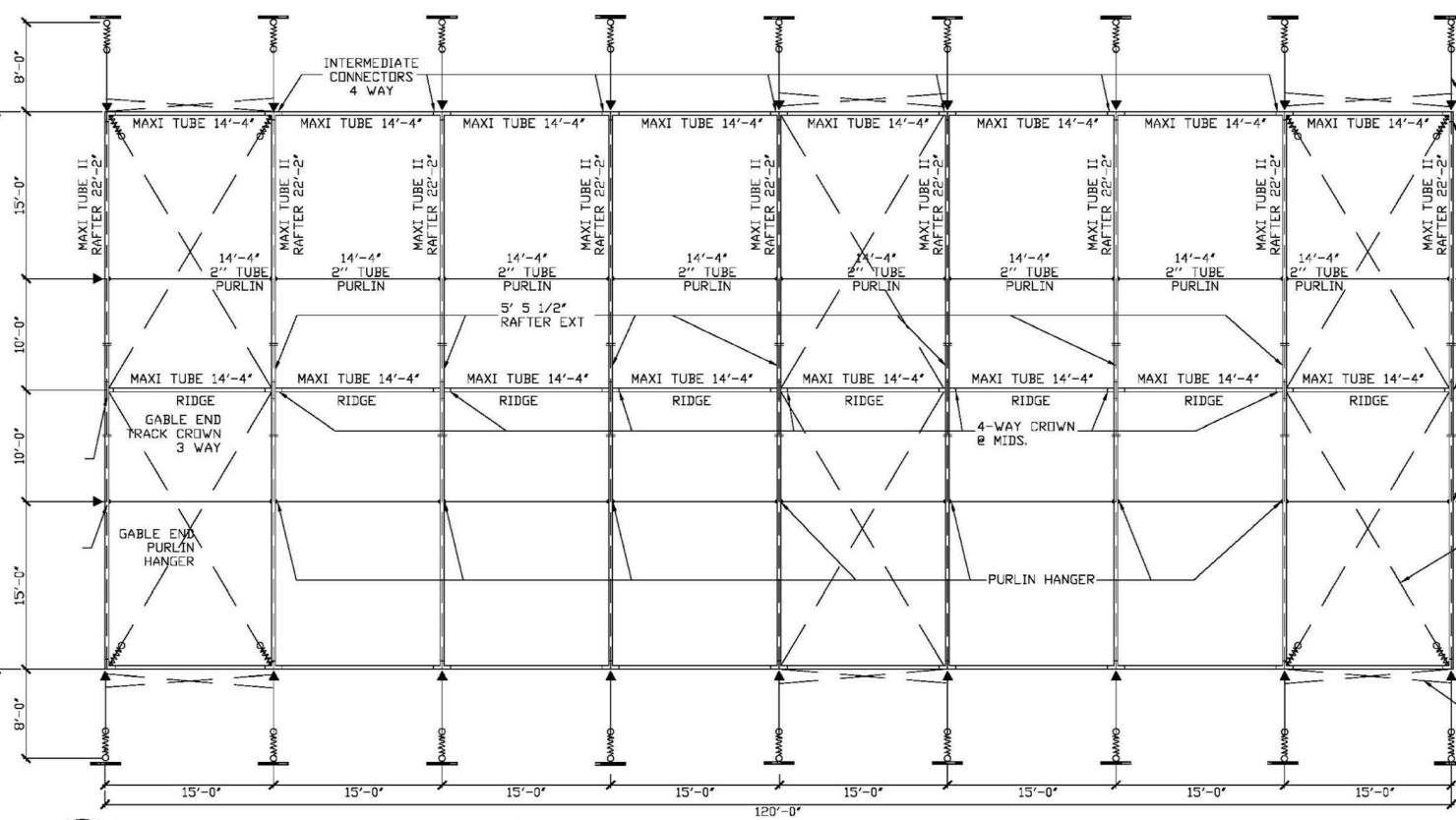
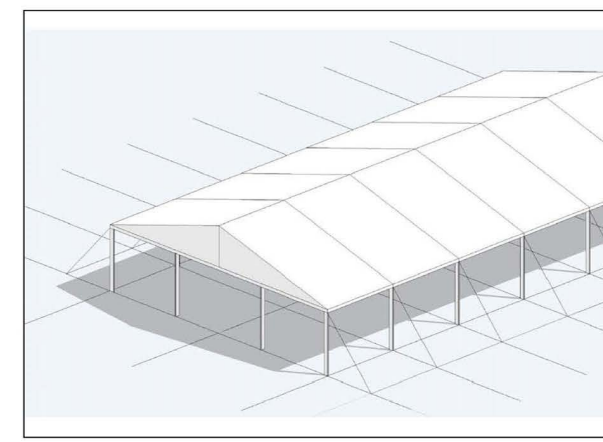

THESE DRAWINGS CONFORM TO THE DESIGN STANDARDS OF ASCE  
7-05 FOR TENTS AS REFERENCED IN THE 2006 IBC /IFC AND THE  
CALIFORNIA CBC 2007 CODES

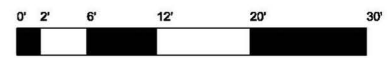

LEGEND OF PARTS

- MAXI TUBE II TRACK RAFTER. EXTRUDED ALUMINUM
- MAXI / MAXI IV TUBE. EXTRUDED ALUMINUM
- 2" ALUMINUM TUBE
- RAFTER SPLICE
- ROOF CABLE W/ TURNBUCKLE
- SIDE WALL TENSION STRAPS / CABLES
- ANCHOR POINTS FOR ROOF TENSION STRAPS
- OUTGUY ANCHOR / LOAD BARS
- BRACE BARS
- ALL CONNECTORS ARE STEEL AND PLATED FOR LONG LIFE.

- GENERAL NOTES:  
A. ALL FRAME PARTS SLIP TOGETHER AND ARE PINNED OR BOLTED FOR LONGTERM INSTALLATIONS  
B. MID SECTIONS OF 10', 15' & 20' CAN BE ADDED TO EXTEND TENT TO ANY LENGTH.  
C. MIDST FRAME PARTS CAN BE UTILIZED IN 30', 40' & 50' TENT SYSTEMS.

50' MAXIMIZER TUBE FRAME  
GABLE END TENT

50' X 120' STRUCTURE  
ROOF PANELS: 2 GABLE END INFILLS  
8-15' MID TOPS

DATE: 8-1-11	DRAWN BY: M. ETZEL	DRAWING
SCALE: VARIES	©2011 SE CONSULTING DESIGN	

NOTE: FRAME LENGTH MAY BE  
EXTENDED W/ ADDITIONAL MID  
SECTIONS.

2 PLAN - 50' X 120' FRAME GABLE END TENT  
1/8"=1'-0"