

## Meeting Minutes--City of Santa Clara BPAC Subcommittee on Wayfinding

---

Location: Jonathan Marinaro's home

Date: April 22, 2026

Time: 5:30 p.m. to 7:20 p.m.

---

### Attendance:

Jonathan Marinaro (brought laptop with files for use at meeting)

Jorge Haro

Ken Kratz (recording secretary; provided bicycle map, plastic overlay, & pens)

### Agenda Items:

Select destinations to be on the signs that will be placed along the routes.

### Actions:

Selected locations for signs at intersections of the routes. For example: Bay Trail (County route 2) to STACT (County route 16), 200 to Guadalupe River Trail (County route 9), 200 to STACT (County route 16), 300 to Guadalupe River Trail (County route 9), 200 to 300, 300 to STACT (County route 16), 600 to STACT (County route 16), 600 to 171, Pruneridge (County route 18) to 171, and others.

Selected locations for signs at intersection of route 300 (MCB) and route 16 (STACT) in order to direct cyclists to hairpin turns and ramps leading to the underpass.

Selected locations for signs at intersection of route 300 (MCB) and route 9 (Guadalupe River Trail) through Thamien Park. (Agnew to Garrity to Lick Mill To Thamien park to Guadalupe River Trail).

Started work on selecting destinations and sign legends (words and symbols [glyphs & logos]); completed work on government and transit hub destinations.

**Other Notes:** None

**Next Meeting:** To be determined. Need to continue work on signs: selecting destinations, sign legends and sign locations.

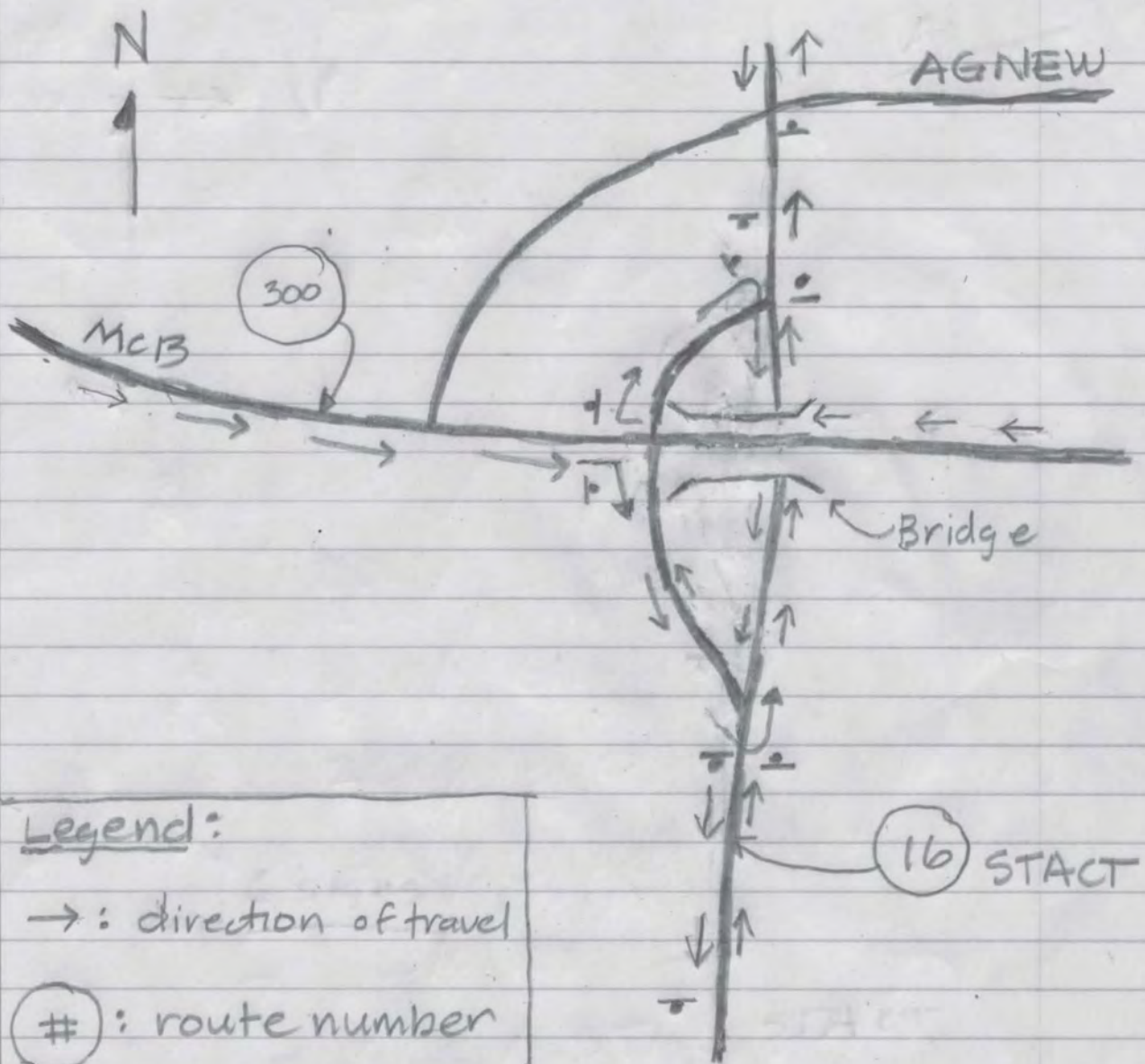

Legend:  
 → : direction of travel  
 (#) : route number  
 ◻ : sign facing direction of travel

PLAN VIEW  
 (NTS)

BPAC Wayfinding Subcommittee  
 Sign Locations  
 MCB @ STACT

DATE: 4/22/26  
 drawn: KRATZ

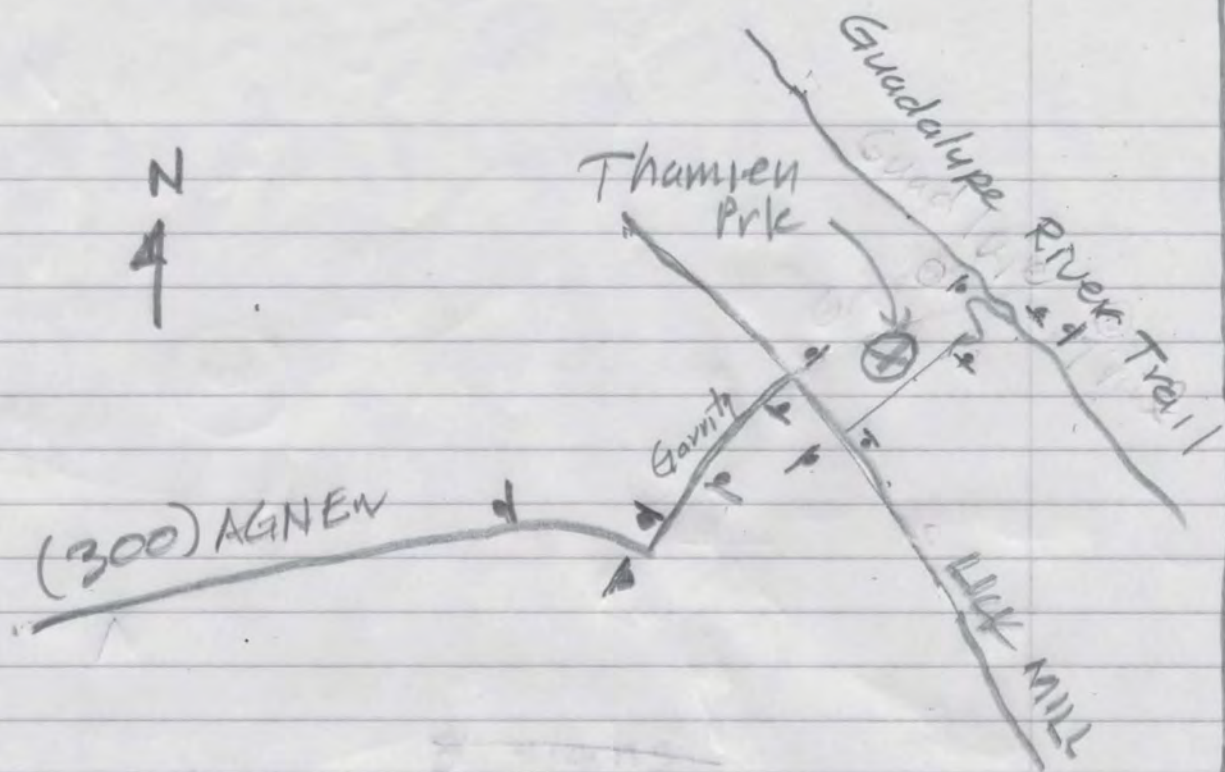

Legend:

→ : direction of travel

Ⓝ : route number

▲ : sign facing direction of travel

PLAN VIEW  
(NTS)

BPAC Wayfinding Subcommittee  
Sign Locations  
Route 300 to Guadalupe River Trail

date: 4/22/26  
drawn:  
KRATZ

BPAC Wayfinding Subcommittee  
List of Route Intersections  
April 22, 2026

Intersections of routes (north to south):

N/O Highway 101:

Bay Trail/Guadalupe River Trail

Bay Trail/STACT

200/Guadalupe River Trail

200/STACT

200/200 (turn)

300//Guadalupe River Trail

300/300 (turn)

200/300

300 turn (around Mission College to the north)

300 turn (around Mission college to the south)

300/STACT

S/O Highway 101:

600/STACT

600/171

18/171

## Meeting Minutes--City of Santa Clara BPAC Subcommittee on Wayfinding

---

Location: Jonathan Marinaro's home

Date: May 12, 2026

Time: 6:30 pm. to 8:30 pm.

---

### Attendance:

Present:

Jorge Haro

Ken Kratz (recording secretary; provided bicycle map, plastic overlay, & pens)

Absent:

Jonathan Marinaro

### Agenda Items:

Continued selection of destinations to be on the signs that will be placed along selected routes.

### Actions:

Continued work selecting destinations and sign content (descriptions of destination through words, glyphs & logos) and the selection of appropriate routes for those destinations.

Completed work on the last two categories of destinations:

III: Points of Interest & Services,

IV. Commerce, Businesses, Hospitals, Nearby Points of Interest near City limits & Misc.

This completes work the selection of sign content and routes for those destinations for all the categories of destinations selected by the Subcommittee.

**Other Notes:** None

**Next Meeting:** To be determined. Need to select destinations for inclusion on particular signs along the selected routes. The number of destinations per sign may be restricted to only a few destinations in order to fit on a standard sign.

City of Santa Clara BPAC Wayfinding Subcommittee  
List of Possible Destinations Along Routes  
March 29, 2026  
(revised 4/22/2026, started word, symbol and route selections)  
(revised 5/12/2026, completed word, symbol and route selections)  
(compiled by Ken Kratz)

**Legend:**

G: GLPH

L: Logo

W: Words

N: no sign (destination is not near proposed routes; destination is struck out for historical record)

?: to be determined

C: closed

(...): route selection

**Destinations:**

**I. Government:**

Federal:

G: Post Offices:

Sanchez Annex on Walsh Ave. near Scott Blvd.

Santa Clara in downtown Franklin mall

Mission Santa Clara on Kiely at Benton

Agnew Post Office on Lafayette Street at Eisenhower

N: ~~Immigration Office~~

State:

L: Department of Motor Vehicles, (Flora Vista Ave.)

?: Schools: Elementary, Middle School, High School, Junior College, College

County:

C: ~~Santa Clara County Court House (1095 Homestead Road between Main and Washington St.)~~

City:

N: ~~City Hall~~

G: Police Station

G: Police Northside Substation (3992 Rivermark Parkway [at Harrigan] in Rivermark)

N: ~~Fire Stations~~

G: Libraries (Central, Mission and Northside Branch)

N: ~~Dept. Of Public Works Corporation Yard (1700 Walsh Avenue)~~

G: Parks: (<https://www.santaclaraca.gov/our-city/departments-g-z/parks-recreation/parks-and-facilities>

recreational facilities, picnic facilities, bathrooms)

G (STACT): Central Park

G (STACT): Swim Center

G (STACT) Central Library

G (STACT) Northside Library

?: Mission Branch Library

W (300): Reed & Grant Sports Park (recreation fields); 750 Reed Street

G (600): Larry Marsalli Park (ECR at De La Cruz)

G (300): Montague Park and Aquatic Center (public pool and park; 3595 MacGregor Lane )

W (300): Agnews Historic Park & Mansion (4030 Lafayette St.)

N: ~~Memorial Cross Park (412 Martin Ave.)~~

N: ~~Lawrence Station community (park, community room; 2985 Feliz Rd.)~~

N: ~~Community Recreation Center (recreation, classes; 969 Kiely Blvd, CSC)~~

G (STACT & 600): Youth & Teen Activity Center (recreation programs for youth; 2466 Cabrillo Avenue)

G (STACT & 600): Skate Park (at Youth & Teen Activity Center on Cabrillo)

N: ~~Lou Vierra Baseball Field (part of Bowers Park on Cabrillo)~~

W (600): Senior Center (1303 Fremont Street)

W: Historical and Landmarks (Buildings, Commemorative Sites, Historic Tours)  
(600) The Adobe

G (600): Triton Museum (Ca. art museum; 1505 Warburton Ave. Across from City Hall)

N: ~~San Tomas Aquino Creek Trail~~

G (200): Youth Soccer Park (5020 Stars and Stripes Road)

## II. Transportation Hubs:

Bus: VTA;

G (600): Santa Clara Transit Center (1005 Railroad Avenue);

N: ~~Westfield Valley Fair (transit hub on Forest Avenue at mall in S.J)~~

G, L (200): Light Rail stations: (VTA light rail stations in SC):

Lick Mill  
Great America  
Old Ironsides  
Reamwood

G, L Heavy Rail:

CalTrain,  
ACE Train  
Amtrak (Capitol Corridor stations):  
CalTrain station at Lawrence Expwy.  
Santa Clara Transit Center (CalTrain & Amtrak; 1005 Railroad Avenue)

Plane:

G (300, on Guadalupe River Trail) San Jose International Airport

### III. Points of Interest and Services:

L, S (200), (16), (9), (2): Santa Clara Convention Center

L, S (200), (16), (9), (2): Levis Stadium

?: Great America (amusement park; will be closing)

S (600), (16): Triton Museum (contemporary California art; Warburton Ave., near City Hall)

S (600) Franklin Mall

L?, S (600): Santa Clara Mission (Logo with Mission bell?)

L, S (600): Santa Clara University (higher education institution; 500 El Camino Real) (Logo with building and text)

S? (600) de Saisset Museum (museum of art and history at Santa Clara University)

S Santa Clara ~~Transit Center~~ Train Station Museum (commuter trains stop, historic depot, library, museum, model trains; 1005 Railroad Avenue, CSC) (Sign for museum?)

L,S (300), (16): Intel museum (electronic manufacturing museum; 2200 Mission College Blvd. CSC)

S (600): Women's Club Adobe (historic meeting place; 3260 the Alameda, CSC) (existing signs to be considered)

N: ~~Harris-Lass Historic Preserve (historic home and grounds, museum)~~

N: ~~Mission City Memorial Park (cemetery, trees, first settlers,; 420 N. Winchester Blvd, CSC)~~

S (300): Agnews State Hospital (historical buildings and grounds); 4030 Lafayette Street, CSC.

S (300), (9) Agnews Historic Cemetery (historic; 1250 Hope Drive, CSC)

S (200), (9): Ulistac Natural Area (open space, regional and cultural resource; 4901 Lick Mill Blvd., CSC)

S (16), (9): Everett N. "Eddie" Souza Park (public garden on STACT trail, Monroe St. @ ST Expwy)

N: ~~Silicon Valley Chamber of Commerce & Innovation (3350 Scott Blvd.)~~

S (600): Historic sites and buildings: Carmelite Monastery (1000 Lincoln St.)

S (600): Places registered in the National Register of Historic Places: Morse Mansion (981 Fremont St.)

N: ~~Berryessa Adobe (historic adobe home & museum; 373 Jefferson St., CSC)~~

S (200), (300), (16), (9): John W. Christian Greenbelt (Sunnyvale bike path connecting to Mission College)

L,S (171): Kaiser Hospital

S (16), (600): Youth Activity Center (on Cabrillo near San Tomas Expressway)

S (16), (600): Skate Park (on Cabrillo near San Tomas Expressway)

#### **IV. Commerce, Businesses, Hospitals, Nearby Points of Interest near City limits, Misc.:**

L,S (171): Hospitals:

l, S (171): Kaiser Hospital

N: ~~O'Connor Hospital~~

S: Bicycle repair:

S (16): Off Ramp,

N: ~~Sports Basement~~

?: Sports Authority (is this store existing at Westfield Valley Fair?)

N: ~~Santa Clara Farmers Market (produce market); 950 Jackson St. btwn. Benton and Homestead Rd)~~

S (600): Westfield Valley Fair (shopping and bus hub connection; 2855 Stevens Creek Blvd, Santa Clara)

L, S (600), (171), (18): Apple Park (Apple headquarters campus & visitor center; Cupertino, S.E. crnr of Homestead and Tantau).

S (171), (2), (9): Don Edwards S.F. Bay National Wildlife Refuge (wildlife, trails; 1751 Grand Blvd., San Jose)

S (16, (2): Sunnyvale Baylands Park (recreation, trails, picnic; 999 E Caribbean Dr, Sunnyvale)

N: ~~Santana Row (San Jose, 377 Santana Row, Stevens Creek Blvd and Winchester)~~

N: ~~Winchester Mystery House (San Jose, 525 S. Winchester Blvd.)~~

L, S (171): Salvation Army Citadel (food pantry, recreation & social activities; 3090 Homestead Road)

S (171): SCUSD Farm (Sunnyvale, Peterson Middle School campus, 1380 Roasalia Ave.)

N: ~~Cyprus Avenue (connection to San Jose; bridge over 280; bridge on Constance Drive. Cyprus)~~

L,S (171), (600), (16), Historic El Camino Real (to complement existing signs and hanging bells along road)

S (171): Korean town (Korean restaurants)

N: ~~Silicon Valley Central Chamber of Commerce (3350 Scott Blvd.)~~