



# CORESITe SV9

**NEW DATA CENTER BUILDING**  
SANTA CLARA, CA

PCC SUBMISSION : VOLUME 4



**CORGAN**  
PROJECT NUMBER: 19199  
ISSUE DATE: 05.28.2020



**PEOPLES ASSOCIATES**  
STRUCTURAL ENGINEERS

**Kimley»Horn**  
Expect More. Experience Better.



## DATA MATRIX

**LOT SQUARE FOOTAGE:**  
~170,000 SQ FT

**LOT COVERAGE:**  
~58,000 SQ FT (34%)

**EXISTING USE:**  
EXISTING 1-STORY COMMERCIAL BUILDING

**EXISTING SQ FT:**  
~54,000 SQ FT

**PROPOSED USE:**  
LIGHT INDUSTRIAL  
NEW 4-STORY DATA CENTER  
WITH SCREENED ROOFTOP  
EQUIPMENT PLATFORM

**PROPOSED SQ FT:**  
~250,000 SQ FT

**PROPOSED OCCUPANCIES:**  
BUSINESS & S-1

**REQUIRED PARKING:**  
250,000 SQ FT @ 1 PER 2,500 =  
100 SPACES

**ACTUAL USE DATA CENTER:**  
10 FULL-TIME STAFF  
15 VISITORS  
25 TOTAL SPACES

**PROPOSED PARKING:**  
26 SPACES

## SHEET LIST

**GENERAL**  
COVER SHEET  
EX-00 - SITE PLAN DEMOLITION

**CIVIL**  
C1.0 - FIRE TRUCK ACCESS PLAN  
C2.0 - FIRE DEPARTMENT WATER  
SUPPLY PLAN  
C3.0 - GRADING AND DRAINAGE PLAN  
C4.0 - PRELIMINARY DRAINAGE AREA  
MAP  
C5.0 - COMPOSITE LANDSCAPE AND  
UTILITY PLAN

**LANDSCAPE**  
L1.0 - TREE DISPOSITION PLAN  
L1.1 - TREE INVENTORY AND  
ARBORIST REPORT  
L1.2 - DISPOSITION DETAILS  
L2.0 - LANDSCAPE PLAN  
L2.1 - LANDSCAPE NOTES  
AND SCHEDULE  
L2.2 - LANDSCAPE DETAILS

**ARCHITECTURAL**  
EX-01 - SITE PLAN  
EX-02 - FLOOR PLAN - LEVEL ONE  
EX-03 - FLOOR PLAN - LEVEL TWO  
EX-04 - FLOOR PLAN - LEVEL THREE  
EX-05 - FLOOR PLAN - LEVEL FOUR  
EX-06 - EXTERIOR ELEVATIONS  
EX-07 - EXTERIOR ELEVATIONS  
EX-08 - BUILDING SECTIONS



CORGAN  
401 N. HOUSTON ST  
DALLAS, TX 75202  
T. 214-748-2000

**ISSUES**

1	09.16.2019	PCC SUBMISSION
2	10.28.2019	PCC SUBMISSION #1
3	01.18.2020	PCC SUBMISSION #2
4	05.28.2020	PCC SUBMISSION #3
5		
6		
7		
8		
9		
10		

**REVISIONS**

1		
2		
3		
4		
5		
6		
7		
8		
9		
10		

This document is incomplete and may not be used for regulatory approval, permit or construction.

Date of issue: **08.26.2020**

**CORESITE SV9**  
PCC SUBMISSION  
2905 STENDER WAY  
SANTA CLARA, CA 95054

SITE PLAN  
DEMOLITION

JOB 19199.0000  
DATE 09.16.2019  
SHEET

**EX - 00**

5/27/2020 1:22:38 PM EX - 00 SITE PLAN DEMOLITION

1 EXISTING SITE PLAN  
1" = 20'-0"



K:\MKT\19252001 - SV9 CORESITE\CAD\DWG\19252001-FIRE HYDRANT AND ACCESS PLANING 5-29-2020 BLN.PIN REVISION.dwg

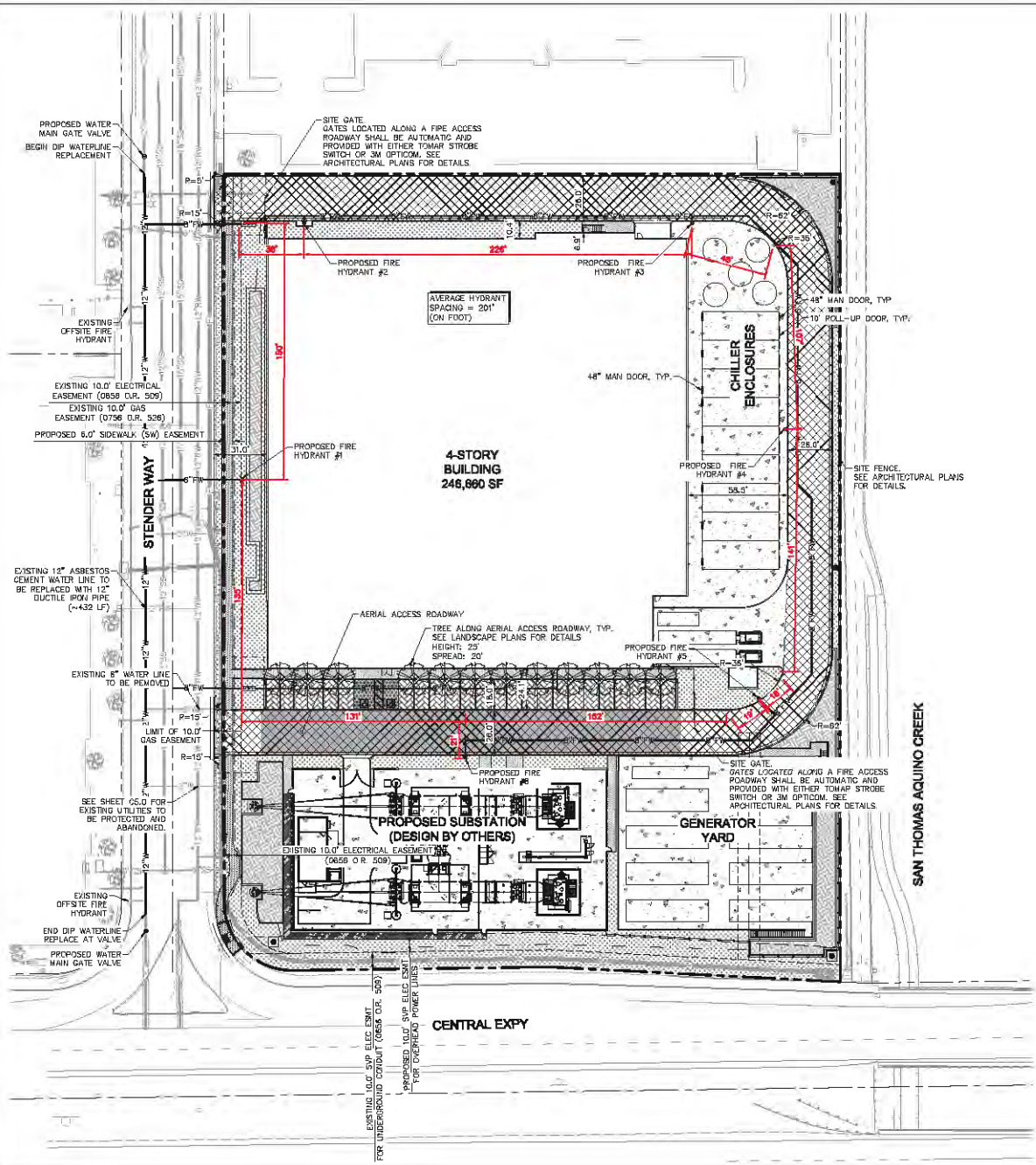

**LEGEND**

- PROPERTY LINE
- PROPOSED FIRE WATER LINE
- EXISTING WATER LINE
- LANDSCAPE/PLANTER AREA
- FIRE ACCESS LANE / EMERGENCY VEHICLE ACCESS EASEMENT (EVAE)
- AERIAL ACCESS ROADWAY
- STANDARD DUTY CONCRETE PAVEMENT
- HEAVY DUTY CONCRETE PAVEMENT
- PERMEABLE PAVERS
- BIORETENTION AREA

**SITE DATA**

BUILDING CONSTRUCTION TYPE:	IIA
TOTAL BUILDING SQUARE FOOTAGE:	246,660 SF
REQUIRED FIRE FLOW (PER CFC TABLE B103.1, BEFORE REDUCTION):	6,000 GPM
MINIMUM REQUIRED HYDRANTS (PER CFC TABLE C102.1):	6 HYDRANTS
HYDRANTS PROVIDED:	6 HYDRANTS
AVERAGE HYDRANT SPACING:	200 FT

**HYDRANT SPACING TABLE (ON FOOT)**

HYDRANT PATH	TOTAL DISTANCE
HYDRANT 1 TO 2	231 FEET
HYDRANT 2 TO 3	228 FEET
HYDRANT 3 TO 4	158 FEET
HYDRANT 4 TO 5	159 FEET
HYDRANT 5 TO 6	192 FEET
HYDRANT 6 TO 1	243 FEET
TOTAL	1,303 FEET
AVERAGE	209 FEET

**Kimley-Horn**

2505-2509 STENDER WAY,  
SANTA CLARA, CA 95054

PHONE: 650-900-4130 FAX: 714-938-9488  
WWW.KIMLEY-HORN.COM



ENGINEER OF RECORD SEAL

**CORESITE - SV9**

2505-2509 STENDER WAY,  
SANTA CLARA, CA 95054

JOB NO.: 19252001  
PRINT DATE: 05/28/2020  
DESIGNED BY: KN  
CHECKED BY: MJ

SET ISSUED:  
10/28/2019 PCC SUBMITTAL 1  
02/12/2020 PCC SUBMITTAL 2  
02/24/2020 SCHEMATIC DESIGN  
05/28/2020 PCC SUBMITTAL 3

SHEET NAME:  
**FIRE TRUCK ACCESS PLAN**

SHEET NO.: **C1.0**

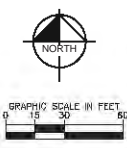



R:\M\1461\1461\1461-01 - SV9 (CORESITE)\CADD\SUBMITTALS\CONTRACT DRAWINGS\CD3 PRELIM GRADING AND DRAINAGE PLAN.DWG 5/26/2020 6:58 PM HORN, KAHN

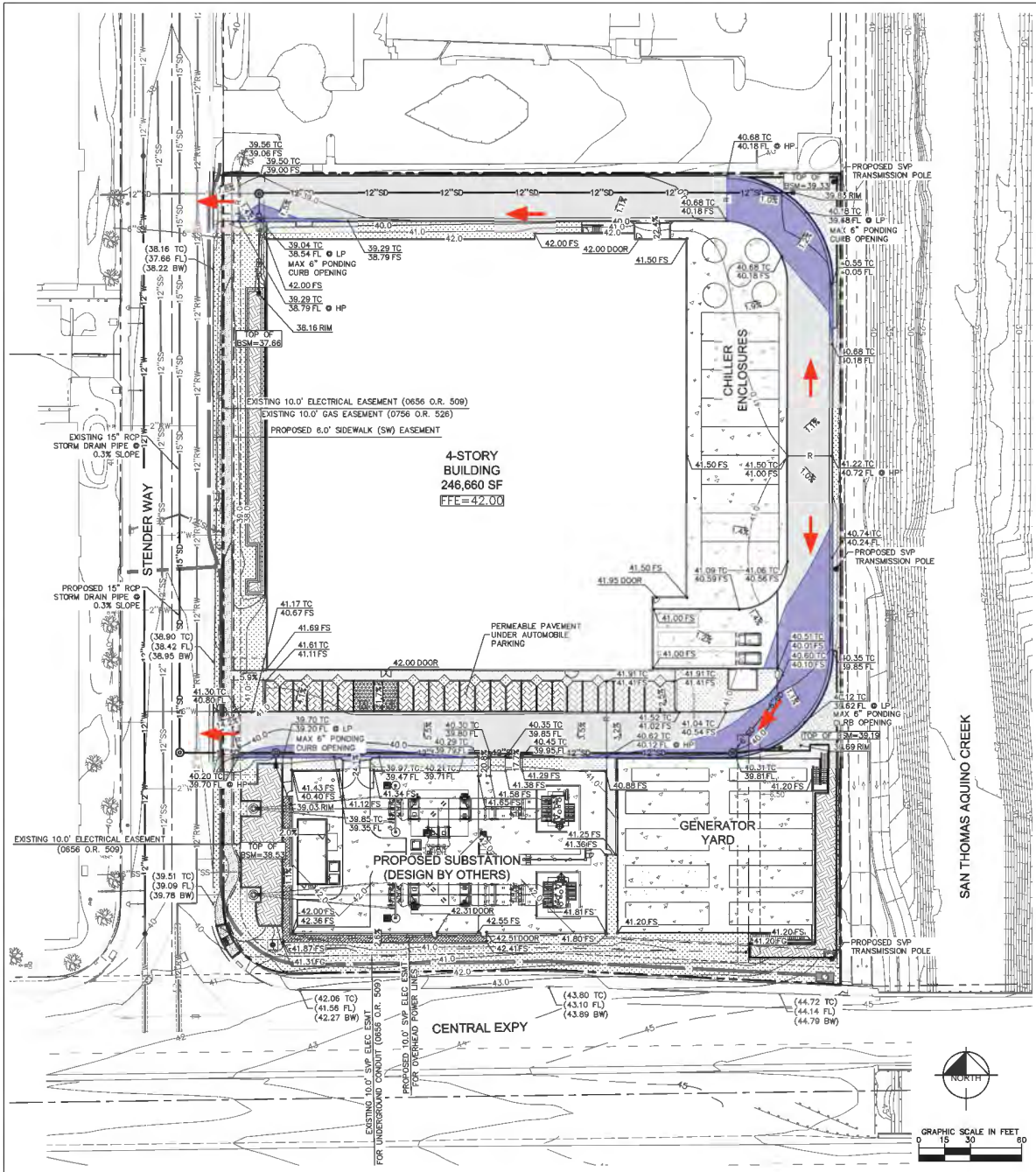

**LEGEND**

—	PROPERTY LINE	[Symbol]	LANDSCAPE/PLANTER AREA
- - -	EASEMENT/SETBACK LINE	[Symbol]	BIORETENTION AREA
R	RIDGE LINE	[Symbol]	PERMEABLE PAVEMENT
GB	GRADE BREAK LINE	[Symbol]	ASPHALT CONCRETE PAVEMENT
—	FLOW LINE	[Symbol]	STANDARD DUTY CONCRETE PAVEMENT
—	STORM DRAIN LINE	[Symbol]	HEAVY DUTY CONCRETE PAVEMENT
- - -	PERFORATED PIPE	[Symbol]	OVERLAND RELEASE PONDING LIMITS (6" MAXIMUM)
LP	LOW POINT		
HP	HIGH POINT		
BSM	BIO-SOIL MIX		
+	DROP INLET		
→	OVERLAND RELEASE PATH		

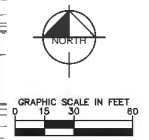
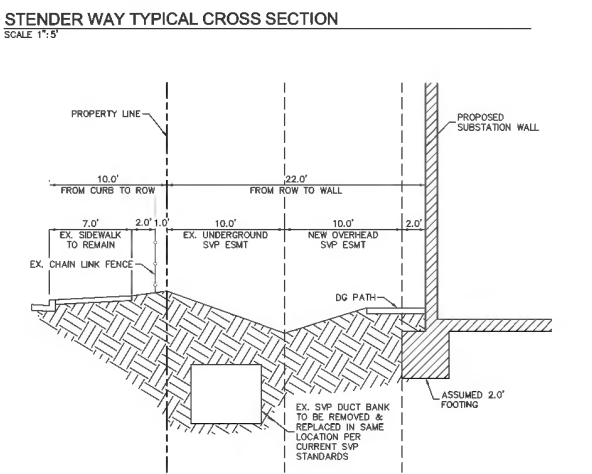
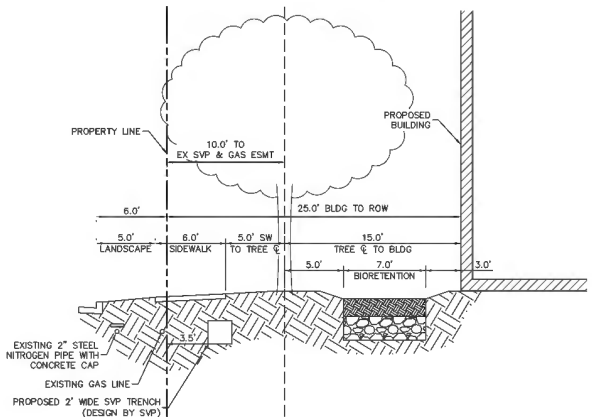

**Kimley-Horn**  
 • 4020 KIMLEY-HORN AND ASSOCIATES, INC.  
 10 SOUTH ALAMEN BLVD, SUITE 1250  
 SAN LUIS OBISPO, CA 95113  
 PHONE: 869-800-4130 FAX: 714-938-9488  
 WWW.KIMLEY-HORN.COM

ENGINEER OF RECORD  
 SEAL

IT IS A CONDITION OF THIS CONTRACT AND FEES THAT THE CLIENT SHALL BE RESPONSIBLE FOR OBTAINING ALL NECESSARY PERMITS AND APPROVALS FROM ALL APPLICABLE AGENCIES AND AUTHORITIES. THE CLIENT SHALL BE RESPONSIBLE FOR OBTAINING ALL NECESSARY PERMITS AND APPROVALS FROM ALL APPLICABLE AGENCIES AND AUTHORITIES. THE CLIENT SHALL BE RESPONSIBLE FOR OBTAINING ALL NECESSARY PERMITS AND APPROVALS FROM ALL APPLICABLE AGENCIES AND AUTHORITIES.

**CORESITE - SV9**  
 2505-2509 STENDER WAY,  
 SANTA CLARA, CA 95054

JOB NO.: 197252001  
 PRINT DATE: 05/28/2020  
 DESIGNED BY: KN  
 CHECKED BY: MJ  
 SET ISSUED: PCC SUBMITTAL 1  
 02/12/2020 PCC SUBMITTAL 2  
 02/24/2020 SCHEMATIC DESIGN  
 05/28/2020 PCC SUBMITTAL 3

SHEET NAME:  
**GRADING AND DRAINAGE PLAN**

SHEET NO.:  
**C3.0**

A.P.N.: 04-39-023

K:\MKT\REV\17722020 - SV9 (CORESITE)\CADD\DWG\PREL\PREL\STORMWATER\CONTRC\_P\DWG\2020\2020\_03\_09\_PN\_PREL.DWG

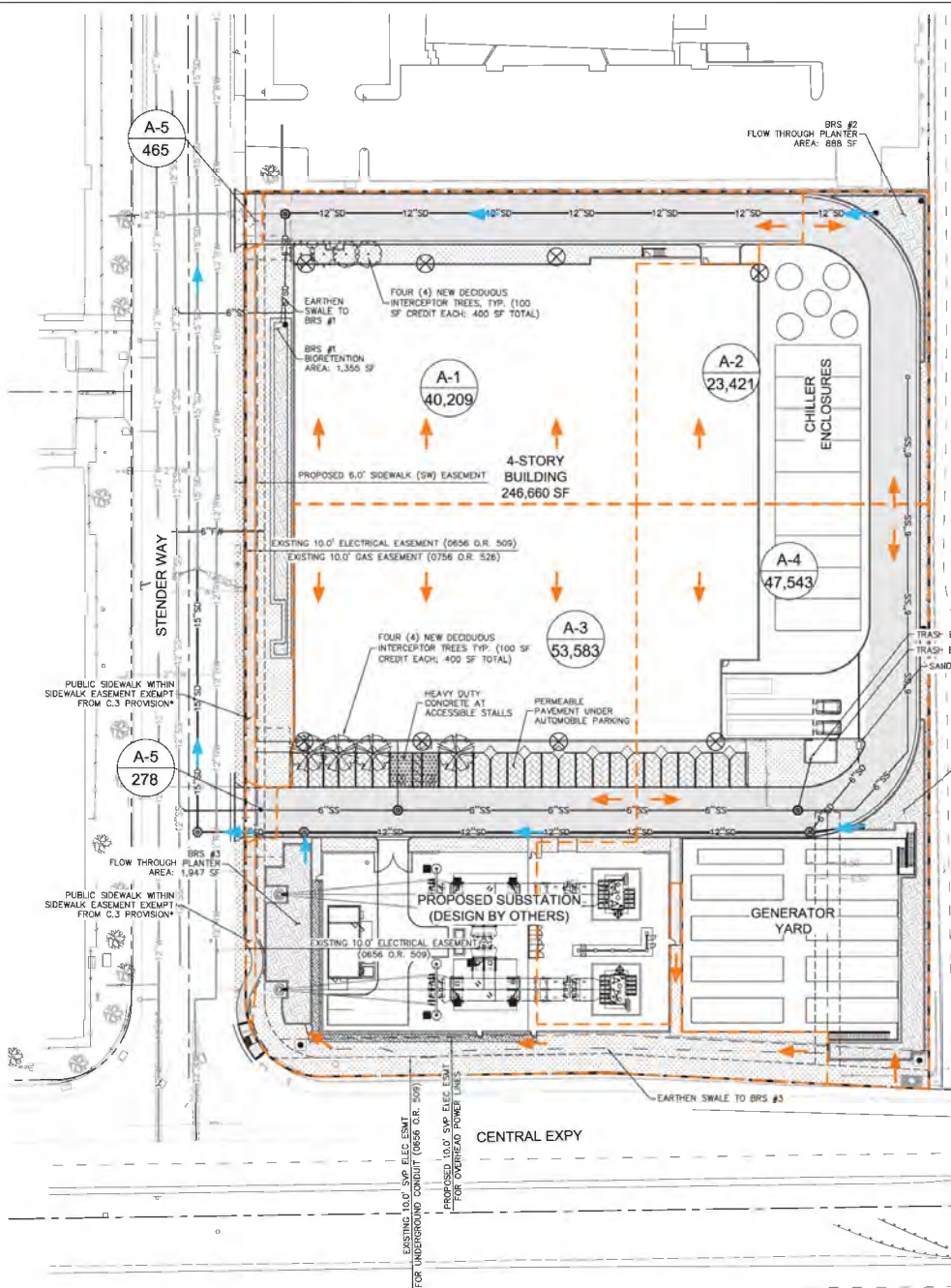

**LEGEND**

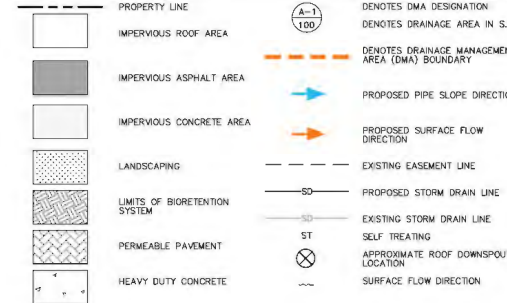

**EARTHWORK**

CUT: 3120 CY  
 FILL: 4430 CY  
 FILM: 1310 CY (FILM)

THE ABOVE QUANTITIES ARE APPROXIMATE IN PLACE VOLUMES CALCULATED FROM THE EXISTING GROUND TO THE PROPOSED FINISHED GRADE. EXISTING GROUND IS DEFINED BY THE CONTOURS AND SPOT GRADES ON THE BASE SURVEY. PROPOSED FINISHED GRADE IS DEFINED AS THE FINAL GRADE AS INDICATED ON THE GRADING PLANS.

THE EARTHWORK QUANTITIES ABOVE ARE FOR PERMIT PURPOSES ONLY. THEY HAVE NOT BEEN FACTORED TO ACCOUNT FOR CHANGES IN VOLUME DUE TO BULKING, CLEARING AND GRUBBING, SHRINKAGE OVER-EXCAVATION AND RE-COMPACTION, AND CONSTRUCTION METHODS. NOR DO THEY ACCOUNT FOR THE THICKNESS OF PAVEMENT SECTIONS, FOOTINGS, SLABS, REUSE OF PULVERIZED MATERIALS THAT WILL UNDERLIE NEW PAVEMENTS, ETC. THE CONTRACTOR SHALL RELY ON THEIR OWN EARTHWORK ESTIMATES FOR BIDDING PURPOSES.

**HYDROMODIFICATION APPLICABILITY**

1. PER THE HYDROMODIFICATION MANAGEMENT PLAN (HMP) APPLICABILITY MAP FOR THE CITY OF SANTA CLARA, THIS PROJECT IS IN THE AREA CONSIDERED "CATCHMENTS DRAINING TO HARVESTED CHANNEL AND/OR TIDAL AREAS, THEREFORE HM IS NOT REQUIRED FOR THIS PROJECT."

**STORMWATER TREATMENT SUMMARY TABLE**

DMA #	TOTAL AREA (SF)	PERVIOUS AREA (SF)	IMPERVIOUS AREA (SF)	EFFECTIVE IMPERVIOUS AREA (SF)	REQUIRED TREATMENT AREA (SF) - 4% OF AREA	PROVIDED BIRETENTION TREATMENT AREA (SF)	TREATMENT FACILITY #	BMP TYPE	INTERCEPTOR TREE CREDIT AREA (SF)
A-1	40,209	7,837	32,372	33,156	1,326	1,355	BRS #1	BIRETENTION	N/A
A-2	23,421	1,552	21,869	22,024	861	888	BRS #2	FTP	N/A
A-3	53,583	14,657	38,926	40,392	1,616	1,947	BRS #3	FTP	N/A
A-4	47,543	6,223	41,320	41,842	1,678	2,120	BRS #4	FTP	N/A
A-5	743	0	743	743	N/A	N/A	N/A	TREE CREDIT - 8 TREES	800
TOTAL	165,499	30,269	135,230*	138,257	5,501	6,310	-	-	800

**IMPERVIOUS VS PERVIOUS AREA**

	TOTAL PROPERTY AREA (SF)	PERVIOUS AREA (SF)	IMPERVIOUS AREA (SF)	PERCENT PERVIOUS
EXISTING	167,268	27,282	140,006	16.31%
PROPOSED	167,268	30,269	137,019*	18.09%

\*PUBLIC SIDEWALK WITHIN SIDEWALK EASEMENT ALONG STENDER WAY FRONTAGE NOT SUBJECT TO C.3 PROVISION; TOTAL OF 1,789 SF IMPERVIOUS AREA

**Kimley-Horn**  
 4020 KIMLEY-HORN AND ASSOCIATES, INC.  
 10 SOUTH ALAMAR BLVD, SUITE 1250  
 SAN JOSE, CA 95113  
 PHONE: 669-800-4130 FAX: 714-938-9488  
 WWW.KIMLEY-HORN.COM

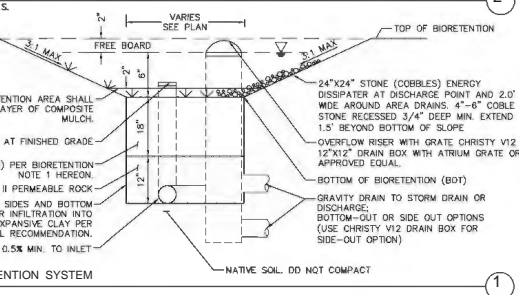
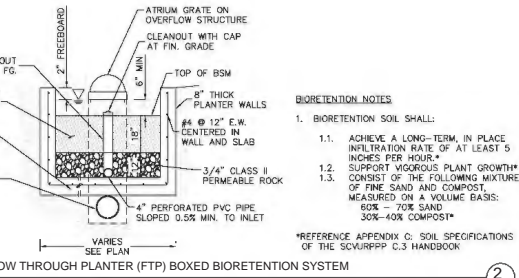

**CORESITE - SV9**  
 2505-2509 STENDER WAY,  
 SANTA CLARA, CA 95054

ENGINEER OF RECORD SEAL

PROJECT: PRELIMINARY DRAINAGE AREA MAP  
 SHEET NAME: C4.0

JOB NO.: 19722020  
 PRINT DATE: 05/28/2020  
 DESIGNED BY: KM  
 CHECKED BY: MJ  
 SET ISSUED: 10/28/2019 PCC SUBMITTAL 1  
 09/12/2020 PCC SUBMITTAL 2  
 02/24/2020 SCHEMATIC DESIGN  
 05/28/2020 PCC SUBMITTAL 3

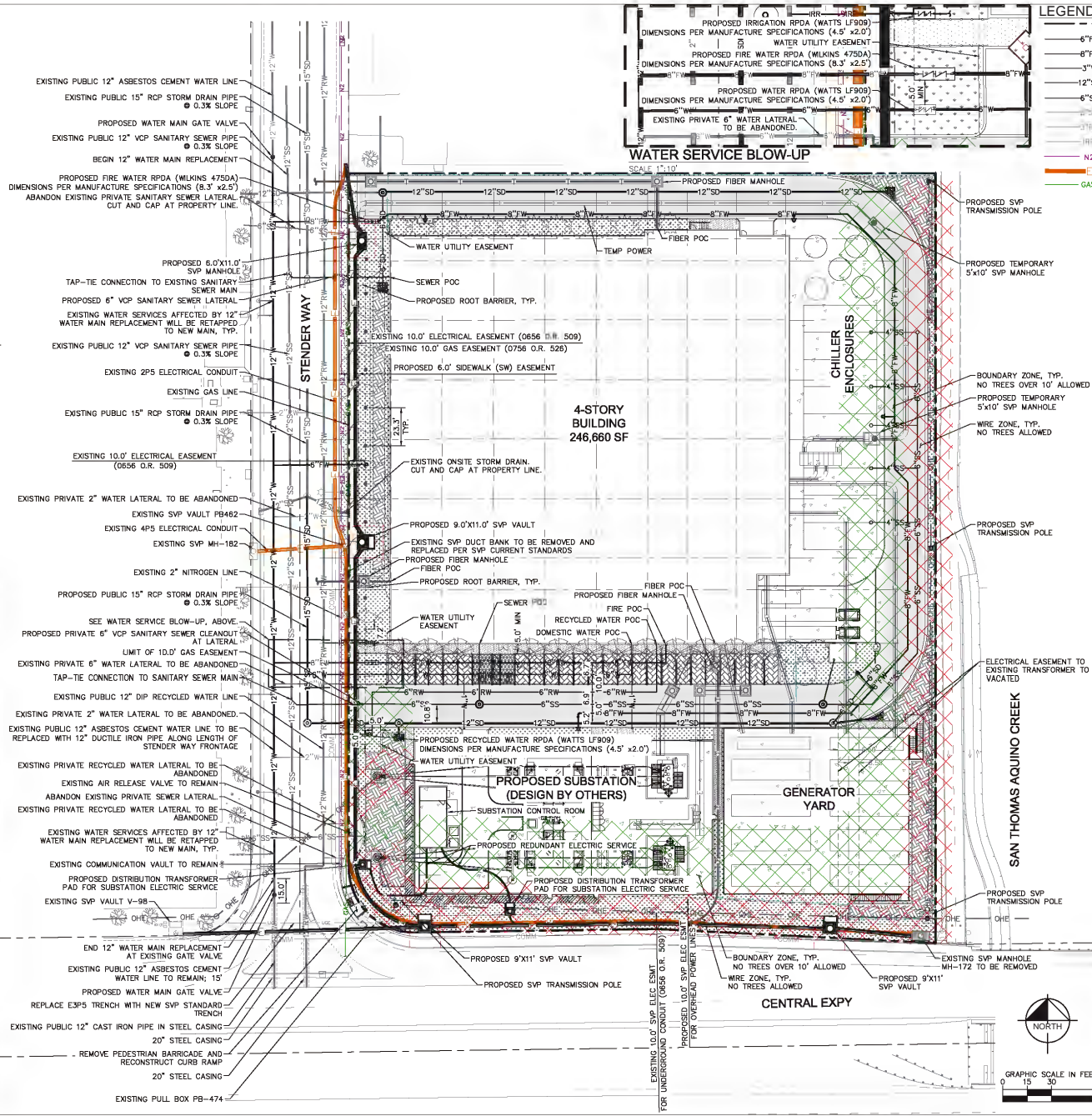

LEGEND	
---	PROPERTY LINE
---	PROPOSED 6" PVC FIRE WATER PIPE
---	PROPOSED 8" PVC FIRE WATER PIPE
---	PROPOSED 3" WATER PIPE
---	PROPOSED 12" STORM DRAIN PIPE
---	PROPOSED 6" STORM DRAIN PIPE
---	PROPOSED 6" SANITARY SEWER PIPE
---	PROPOSED 3" RECYCLED WATER PIPE
---	PROPOSED IRRIGATION PIPE
---	EXISTING 2" STEEL NITROGEN LINE
---	EXISTING SVP DUCT BANK
---	EXISTING 2" PG&E GAS LINE
---	PROPOSED TELECOM/FIBER ROUTE (DESIGN BY OTHERS)
---	PROPOSED ELECTRICAL ROUTE (DESIGN BY OTHERS)
---	PROPOSED OVERHEAD ELECTRICAL ROUTE (DESIGN BY OTHERS)
---	PROPOSED 2" IRRIGATION PIPE
---	FIRE HYDRANT
---	STORM DRAIN MANHOLE
---	SANITARY SEWER MANHOLE
---	STORM DRAIN OVERFLOW INLET

- ### GENERAL NOTES
- A MINIMUM 24" VERTICAL CLEARANCE MUST BE MAINTAINED AT WATER SERVICE CROSSINGS WITH OTHER UTILITIES.
  - THE FOLLOWING MINIMUM HORIZONTAL CLEARANCES MUST BE MAINTAINED BETWEEN WATER SERVICES AND OTHER UTILITIES:
    - 10' FROM SANITARY SEWER UTILITIES
    - 10' FROM RECYCLED WATER UTILITIES
    - 8' FROM STORM DRAIN UTILITIES
    - 5' FROM FIRE AND OTHER WATER UTILITIES
    - 3' FROM ABANDONED WATER SERVICES
    - 5' FROM GAS AND ELECTRIC UTILITIES
    - 5' FROM THE EDGE OF THE PROPOSED OR EXISTING DRIVEWAY
  - A MINIMUM 10' HORIZONTAL CLEARANCE MUST BE MAINTAINED BETWEEN SANITARY SEWER, WATER AND RECYCLED WATER UTILITIES FROM EXISTING AND PROPOSED TREES. IF TREE ROOT BARRIERS ARE INSTALLED, THE CLEARANCE FROM THE TREE REDUCES TO 5'. THE CLEARANCE MUST BE FROM THE EDGE OF THE TREE ROOT BARRIER TO THE EDGE OF THE NAMED UTILITIES.
  - THE BELOW MINIMUM HORIZONTAL CLEARANCES MUST BE MAINTAINED BETWEEN NEW CONDUITS OR PIPING SYSTEMS AND THE FOLLOWING:
    - 5' FROM ANY EXISTING OR PROPOSED SVP CONDUIT SYSTEM
    - 15' FROM POLES AND OPEN TRENCH INSTALLATION. EXCEPTIONS ARE FOR RISER CONDUIT
    - 3' FROM SIGN POSTS, BARRIER PIPES OR BOLLARDS, FENCE POSTS AND SIMILAR STRUCTURES
    - 5' FROM NEW SPLICE BOXES, PULL BOXES, MANHOLES, VAULTS OR SIMILAR SUBSURFACE FACILITIES
    - 5' FROM WALLS, FOOTINGS, RETAINING WALLS, LANDSCAPE PLANTERS, TREE ROOT BARRIERS OR OTHER SUBSURFACE WALL OR STRUCTURE
    - 5' FROM FIRE HYDRANT THRUST BLOCK. THE THRUST BLOCK EXTENDS 5' ON EITHER SIDE OF THE FIRE HYDRANT IN LINE WITH THE RADIAL WATER PIPE CONNECTED TO THE HYDRANT.
    - A MINIMUM 12" VERTICAL CLEARANCE MUST BE MAINTAINED BETWEEN NEW CONDUIT AND PIPE SYSTEMS INSTALLED PERPENDICULAR TO EXISTING SVP CONDUITS FOR OPEN TRENCH INSTALLATIONS.
  - THE BELOW MINIMUM HORIZONTAL CLEARANCES MUST BE MAINTAINED BETWEEN VAULTS/MANHOLES AND THE FOLLOWING:
    - 10' FOOT FROM ADJACENT VAULTS OR MANHOLES
    - 5' FROM ADJACENT CONDUITS
    - 36" FROM FACE OF CURB OR BOLLARDS REQUIRED
  - A MINIMUM 5' HORIZONTAL CLEARANCE IS REQUIRED BETWEEN THE CENTER OF AN ANCHOR LINE AND ANY EXCAVATION AREA.
  - A MINIMUM OF 3.5' HORIZONTAL CLEARANCE IS REQUIRED FROM EXISTING SANITARY SEWER LATERAL TO CONFIRM EXISTING LATERAL IS IN GOOD CONDITION FOR REUSE. LATERAL TO BE REPLACED IF DETERMINED TO NOT BE IN GOOD CONDITION.
  - EXISTING SVP VAULTS AND CONDUIT ARE SHOWN PER CITY OF SANTA CLARA ELECTRICAL UNDERGROUND MAP DRAWING UG275. EXACT AS BUILT LOCATIONS TO BE FIELD VERIFIED BY THE CONTRACTOR AT THE TIME OF CONSTRUCTION.
  - THE PROPERTY SHALL BE FENCED OFF DURING DEMOLITION AND CONSTRUCTION.
  - TREES MUST MEET THE CLEARANCE REQUIREMENTS LISTED IN SVP STANDARDS OH 1230 FOR OVERHEAD LINES AND SD 1235 FOR TREE PLANTING REQUIREMENTS NEAR UTILITY FACILITIES.
  - CONTRACTOR TO CONDUCT CCTV SCAN OF EXISTING SANITARY SEWER LATERAL TO CONFIRM EXISTING LATERAL IS IN GOOD CONDITION FOR REUSE. LATERAL TO BE REPLACED IF DETERMINED TO NOT BE IN GOOD CONDITION.
  - PLANS SHALL CONFORM TO THE FOLLOWING SVP STANDARDS:
    - a. INSTALLATION OF UNDERGROUND SUBSTRUCTURES BY DEVELOPERS
    - b. UG1250 - ENCROACHMENT PERMIT CLEARANCES FROM ELECTRIC FACILITIES
    - c. UG3339 - REMOTE SWITCH PAD
    - d. OH1230 - TREE CLEARANCES FROM OVERHEAD ELECTRIC LINES
    - e. SD1235 - TREE PLANTING REQUIREMENTS NEAR UNDERGROUND ELECTRIC FACILITIES
  - EXISTING FRONTAGE UTILITIES SHOWN IN COLOR FOR CLARITY
  - ALL PROPOSED FIRE WATER LATERALS SHALL BE 6".
  - FIRE SERVICE BACKFLOW ASSEMBLY PER CITY OF SANTA CLARA WATER AND SEWER UTILITIES STANDARD NO. 17. WATER SERVICE BACKFLOW ASSEMBLY PER CITY OF SANTA CLARA WATER AND SEWER UTILITIES STANDARD NO. 11. RECYCLED WATER SERVICE BACKFLOW ASSEMBLY PER CITY OF SANTA CLARA WATER AND SEWER UTILITIES STANDARD NO. 13A.
  - ALL LANDSCAPE WITHIN THE SVP CLEARANCE ZONE AROUND THE SVP MANHOLES AND VAULTS SHALL BE PLANTED WITH LOW LANDSCAPE WITH A MATURE GROWTH HEIGHT OF 12".

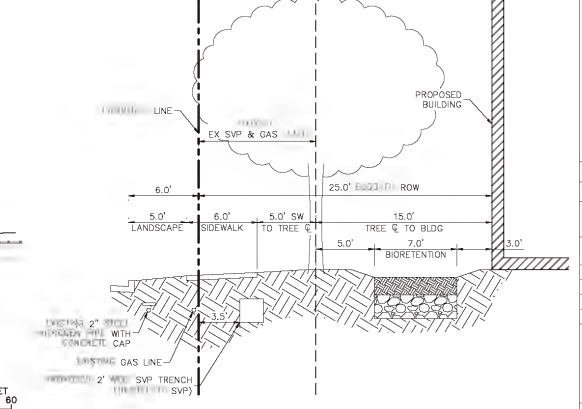

**Kimley-Horn**  
 4000 KIMLEY-HORN AND ASSOCIATES, INC.  
 1500 SOUTH ALHAMBRA BLVD, SUITE 1250  
 SAN JOSE, CA 95113  
 PHONE: 669-800-4130 FAX: 714-938-9488  
 WWW.KIMLEY-HORN.COM

ENGINEER OF RECORD  
 SEAL  
  
 IT IS A CONDITION OF THIS PROFESSIONAL SEAL THAT THE ENGINEER SHALL BE RESPONSIBLE FOR THE DESIGN OF THE PROJECT AND SHALL BE AVAILABLE TO THE CLIENT FOR THE DURATION OF THE PROJECT AND SHALL BE AVAILABLE TO THE CLIENT FOR THE DURATION OF THE PROJECT.

PROJECT NO.: 19725001  
 PRINT DATE: 05/28/2020  
 DESIGNED BY: KN  
 CHECKED BY: MJ  
 SET ISSUED:  
 10/28/2019 PCC SUBMITTAL 1  
 02/12/2020 PCC SUBMITTAL 2  
 02/24/2020 SCHEMATIC DESIGN  
 05/28/2020 PCC SUBMITTAL 3

SHEET NAME:  
**COMPOSITE LANDSCAPE AND UTILITY PLAN**  
 SHEET NO.:  
**C5.0**

JOB NO.: 19725001  
 PRINT DATE: 05/28/2020  
 DESIGNED BY: KN  
 CHECKED BY: MJ  
 SET ISSUED:  
 10/28/2019 PCC SUBMITTAL 1  
 02/12/2020 PCC SUBMITTAL 2  
 02/24/2020 SCHEMATIC DESIGN  
 05/28/2020 PCC SUBMITTAL 3  
 SHEET NAME:  
**COMPOSITE LANDSCAPE AND UTILITY PLAN**  
 SHEET NO.:  
**C5.0**

P:\BAY\_LBDA\17252001\3\_29\_2020\_5\_28\_20.dwg

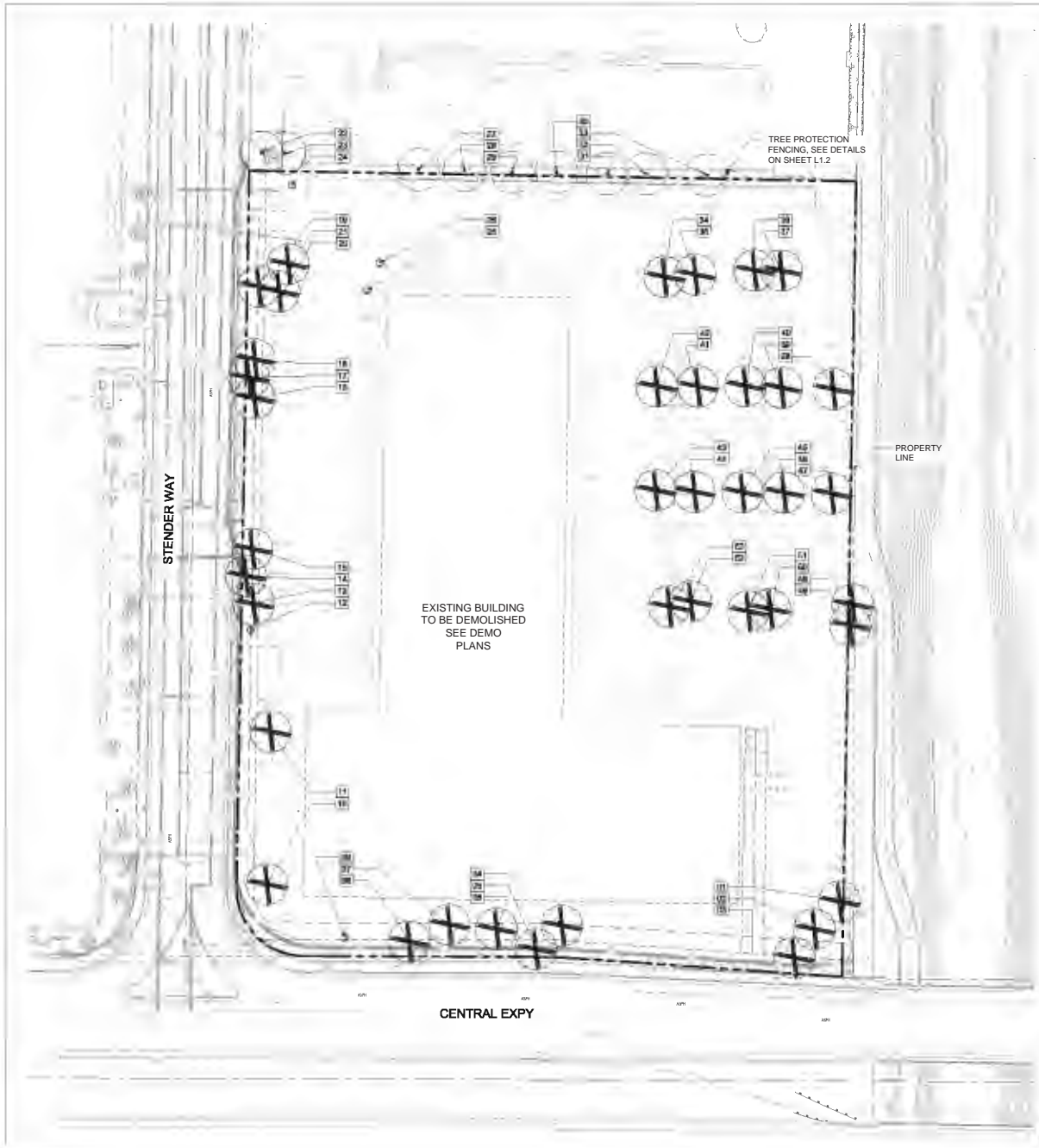

**TREE DISPOSITION LEGEND**

SYMBOL	CODE	QTY	BOTANICAL / COMMON NAME
	XB	5	EXISTING STUMP TO BE REMOVED
	XT	9	EXISTING NEIGHBOR TREE TO REMAIN PROTECT IN PLACE
	ET	30	EXISTING TREE TO BE REMOVED (REFER TO TREE INVENTORY ON SHEET L1.1)

TREE DISPOSITION	
OFFSITE NEIGHBOR TREES TO REMAIN	9
TREES TO BE REMOVED	39

NOTE:  
TREES TO BE REPLACED AT A 2:1 RATIO AT 24" BOX SIZE. TREES MAY BE REPLACED AT A 1:1 RATIO USING A 36" BOX SIZE. CURRENT MITIGATION INFORMATION IS SUBJECT TO CHANGE BASED ON FUTURE PLAN UPDATES.

**SITE PREPARATION NOTES**

- PRIOR TO CONSTRUCTION, THE CONTRACTOR SHALL MEET THE OWNER OR OWNER'S REPRESENTATIVE AND IDENTIFY TREES WHICH ARE TO BE REMOVED AND WHICH ARE TO BE PROTECTED. DO NO CLEARING WITHOUT A CLEAR UNDERSTANDING OF EXISTING CONDITIONS TO BE PRESERVED.
- IF, IN ORDER TO PERFORM EXCAVATION WORK, IT BECOMES NECESSARY TO CUT ROOTS OF PLANTS TO BE SAVED WITHIN THE PROPERTY LIMITS OR LOCATED ON ADJACENT PROPERTY, SUCH ROOTS SHOULD BE CUT NEATLY, COVERED WITH BURLAP AND KEPT MOIST UNTIL ROOTS ARE BACK FILLED.
- TREE REMOVAL SHALL INCLUDE THE FILLING, CUTTING, GRUBBING OUT OF ENTIRE ROOTBALLS AND SATISFACTORY OFF-SITE DISPOSAL OF ALL TREES, SHRUBS, STUMPS, VEGETATIVE AND EXTRANEIOUS DEBRIS PRODUCED BY THE REMOVAL OPERATIONS.
- CONTRACTOR IS RESPONSIBLE FOR ANY DAMAGE INSIDE AND OUTSIDE THE LIMITS OF WORK DUE TO HIS CONTRACT OPERATIONS.
- ALL REFUSE, DEBRIS, UNSUITABLE MATERIALS AND MISCELLANEOUS MATERIALS TO BE REMOVED SHALL BE LEGALLY DISPOSED OF OFF-SITE BY CONTRACTOR.
- CONTRACTOR SHALL VERIFY ALL EXISTING CONDITIONS IN THE FIELD AND REPORT ANY DISCREPANCIES IN THE SITE SURVEY TO THE OWNER OR OWNER'S REPRESENTATIVE PRIOR TO STARTING WORK.

**NOTE TO CONTRACTOR**

- PER COUNTY OF SANTA CLARA TREE PRESERVATION AND REMOVAL GUIDELINES, TREES OF SIGNIFICANT STATUS OR CIRCUMFERENCE (37.7") WITHIN PROJECT LIMITS THAT ARE TO BE REMOVED SHALL REQUIRE A TREE REMOVAL PERMIT. CONTRACTOR SHALL SECURE ALL NECESSARY PERMITS, PRIOR TO BEGINNING ANY CONSTRUCTION WORK.
- ALL TREES WITHIN THE PROJECT LIMITS ARE CALLED OUT FOR REMOVAL, PER PLANS. CONTRACTOR SHALL BE RESPONSIBLE FOR PROTECTING ALL TREES NOT CALLED OUT FOR REMOVAL AND NOT SPECIFICALLY SHOWN ON THESE PLANS IN THE NEARBY VICINITY OF THIS PROJECT. IF THE LIMITS OF DISTURBANCE AFFECT NEARBY TREES TO REMAIN, THE CONTRACTOR SHALL IMPLEMENT TREE PROTECTION MEASURES TO ENSURE EXISTING TREES TO REMAIN ARE PRESERVED THROUGH CONSTRUCTION. REFER TO SHEET L1.2 FOR TREE DISPOSITION DETAILS.
- AFTER CONSTRUCTION IS COMPLETE, THE CONTRACTOR SHALL BE RESPONSIBLE FOR A 90-DAY MAINTENANCE PERIOD FOR ALL PROPOSED AND EXISTING PLANT MATERIAL TO REMAIN. CONTRACTOR SHALL BE RESPONSIBLE FOR THE REPLACEMENT OF ANY DEAD OR IN-DECLINE PLANT MATERIAL AFFECTED BY CONSTRUCTION OR INSTALLED DURING THIS PROJECT FOR AN ADDITIONAL ONE-YEAR GUARANTEE PERIOD. PLANTS THAT DIE DURING THE ONE-YEAR PERIOD SHALL BE REPLACED PROMPTLY IN-KIND AND OF A COMPARABLE SIZE.

**COUNTY OF SANTA CLARA TREE DISPOSITION NOTES**

- FENCING:**  
ALL TREES TO BE RETAINED SHALL BE PROTECTED WITH CHAIN LINK FENCING OR OTHER RIGID FENCE ENCLOSURE ACCEPTABLE BY THE PLANNING OFFICE. FENCED ENCLOSURES FOR TREES TO BE PROTECTED SHALL BE ERECTED AT THE DRIPLINE OF TREES OR AS ESTABLISHED BY THE ARBORIST TO ESTABLISH THE TREE PROTECTIVE ZONE (TPZ) IN WHICH NO SOIL DISTURBANCE IS PERMITTED AND ACTIVITIES ARE RESTRICTED. ALL TREES TO BE PRESERVED SHALL BE PROTECTED WITH MINIMUM 5-FOOT HIGH FENCES ARE TO BE MOUNTED ON 2-INCH DIAMETER GALVANIZED IRON POSTS, DRIVEN INTO THE GROUND TO A DEPTH OF AT LEAST 2 FEET, AT NO MORE THAN 10-FOOT SPACING (SEE DETAIL, AVAILABLE AT WWW.SCCPLANNING.ORG). THIS DETAIL SHALL APPEAR ON GRADING, DEMOLITION AND BUILDING PERMIT PLANS. TREE FENCING SHALL BE ERECTED BEFORE ANY DEMOLITION, GRADING OR CONSTRUCTION BEGINS AND REMAIN IN PLACE UNTIL THE FINAL INSPECTION.
- "WARNING" SIGNS (SEE SAMPLE SIGNAGE DESIGN ON L1.2):**  
A WARNING SIGN SHALL BE PROMINENTLY DISPLAYED ON EACH TREE PROTECTIVE FENCE PER THE REQUIREMENTS OF DEVELOPMENT PURSUANT TO THE SANTA CLARA COUNTY PLANNING OFFICE. (SEE ATTACHED EXAMPLE). THE SIGNS ARE AVAILABLE AT THE PLANNING AND BUILDING INSPECTION OFFICES OR AT WWW.SCCPLANNING.ORG.
- IRRIGATION PROGRAM:**  
IRRIGATE TO WET THE SOIL WITHIN THE TPZ DURING THE DRY SEASON AS SPECIFIED BY THE PROJECT ARBORIST.
- DUST CONTROL PROGRAM:**  
DURING PERIODS OF EXTENDED DROUGHT, OR GRADING, SPRAY TRUNK, LIMBS AND FOLIAGE TO REMOVE ACCUMULATED CONSTRUCTION DUST.



**Kimley-Horn**  
 • 4020 KIMLEY-HORN AND ASSOCIATES, INC.  
 10 SOUTH ALMADEN BLVD, SUITE 1250  
 SAN JOSE, CA 95113  
 PHONE: 669-800-4130 FAX: 714-938-9488  
 WWW.KIMLEY-HORN.COM

LANDSCAPE ARCHITECT OF RECORD SEAL



IT IS A VIOLATION OF THE PROFESSIONAL ENGINEER ACT TO REPRODUCE THESE PLANS IN ANY MANNER WITHOUT THE WRITTEN CONSENT OF THE ENGINEER.

A.P.N.: 104-339-023

**CORESITE - SV9**  
 2505-2509 STENDER WAY,  
 SANTA CLARA, CA 95054

JOB NO.:	197252001
PRINT DATE:	05/28/2020
DESIGNED BY:	MT
CHECKED BY:	MM
SET ISSUED:	
10/28/2019	PCC SUBMITTAL 1
02/12/2020	PCC SUBMITTAL 2
02/24/2020	SCHEMATIC DESIGN
05/28/2020	PCC SUBMITTAL 3

SHEET NAME:  
**TREE DISPOSITION PLAN**

SHEET NO.: **L1.0**





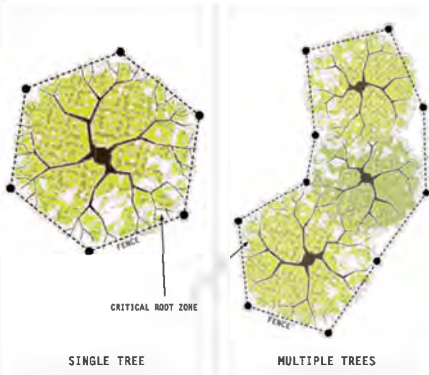

- NOTES:**
1. Tree protection fencing shall be erected at the edge of the critical root zone or beyond prior to the start of any clearing, grading or other construction activity.
  2. Fence shall be minimum 5 feet tall constructed of sturdy material (chain-link or equivalent strength durability).
  3. Fence shall be supported by vertical posts driven 2 feet (min) into the ground and spaced not more than 10 feet apart.
  4. A sign that includes the words, "WARNING: This fence shall not be removed without the expressed permission of the Santa Clara County Planning Office," shall be securely attached to the fence in a visually prominent location.

**TREE PROTECTION FENCE DETAIL**  
PLAN VIEW



**A CITY STANDARD DETAIL**

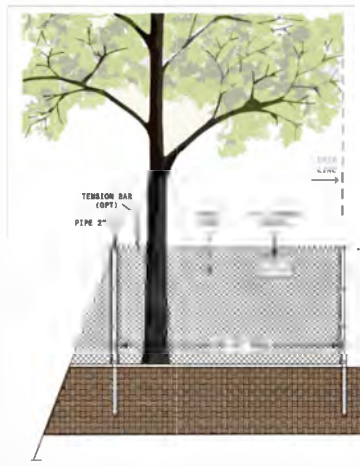

**TREE PROTECTION FENCE DETAIL**  
ELEVATION VIEW



**B CITY STANDARD DETAIL**

ROTATE CURB AWAY FROM TREE



**PLAN VIEW**

- DEMOLITION SEQUENCE:**
1. PERFORM ANY ROOT PRUNING.
  2. INSTALL TREE PROTECTION FENCING.
  3. CAREFULLY REMOVE SIDEWALK AND BASE MATERIAL. COORDINATE ALL DEMOLITION OPERATIONS AROUND PROTECTED TREES WITH ENGINEER AND PROJECT ARBORIST.

- NOTES:**
1. PRIOR TO DEMOLITION ACTIVITIES, COORDINATE WITH OWNER'S REPRESENTATIVE.
  2. ALL TREE PROTECTION MEASURES MUST BE IN PLACE AND APPROVED BY OWNER'S REPRESENTATIVE PRIOR TO DEMOLITION ACTIVITIES.
  3. OWNER'S REPRESENTATIVE TO APPROVE ANY CANOPY THINNING AND/OR CANOPY RAISING PRUNING TO ALLOW FOR DEMOLITION ACTIVITIES PRIOR TO CONSTRUCTION.

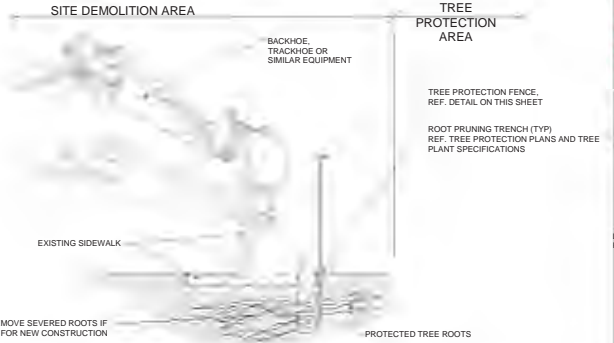

ONLY REMOVE SEVERED ROOTS IF REQUIRED FOR NEW CONSTRUCTION

**C CURB AND SIDEWALK DEMOLITION W/ LANDSCAPE PROTECTION**

# WARNING

This fencing shall not be removed without permission from the Santa Clara County Planning Office: (408) 299-5770

**REMOVAL WITHOUT PERMISSION MAY BE SUBJECT TO FINES**

Santa Clara County Ordinance Code Chapter C16

County of Santa Clara tree protection measures may be found at: <http://www.sccplanning.gov>

WARNING SIGN ON TREE PROTECTIVE FENCE

**D TREE PROTECTION SIGNAGE**

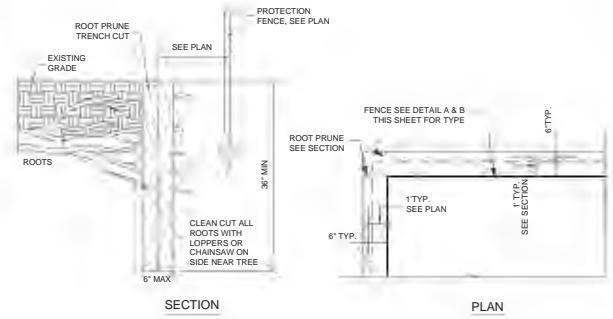

**E ROOT PRUNING**



**Kimley-Horn**  
• 4020 KIMLEY-HORN AND ASSOCIATES, INC.  
• 10 SOUTH ALMADEN BLVD, SUITE 1250  
SAN JOSE, CA 95113  
PHONE: 669-800-4130 FAX: 714-938-9488  
WWW.KIMLEY-HORN.COM

LANDSCAPE ARCHITECT OF RECORD SEAL



IT IS A VIOLATION OF THE STATE AND FEDERAL LAWS TO ACT UNDER THE SIGNATURE OF A LICENSED ENGINEER TO DESIGN OR DRAW THESE PLANS IN ANY WAY.

**CORESITE - SV9**

JOB NO.: 19725001  
PRINT DATE: 05/28/2020  
DESIGNED BY: MT  
CHECKED BY: MM  
SET ISSUED:  
10/28/2019 PCC SUBMITTAL 1  
02/12/2020 PCC SUBMITTAL 2  
02/24/2020 SCHEMATIC DESIGN  
05/28/2020 PCC SUBMITTAL 3

SHEET NAME:  
**DISPOSITION DETAILS**

SHEET NO.: **L1.2**

K:\19\191255001 - SV9 CORESITE/SV9 CORESITE/UTILITIES/IRRAWADDI/LANDSCAPE PLANNING/2/26/2020 7:08 PM IRRAWADDI.dwg

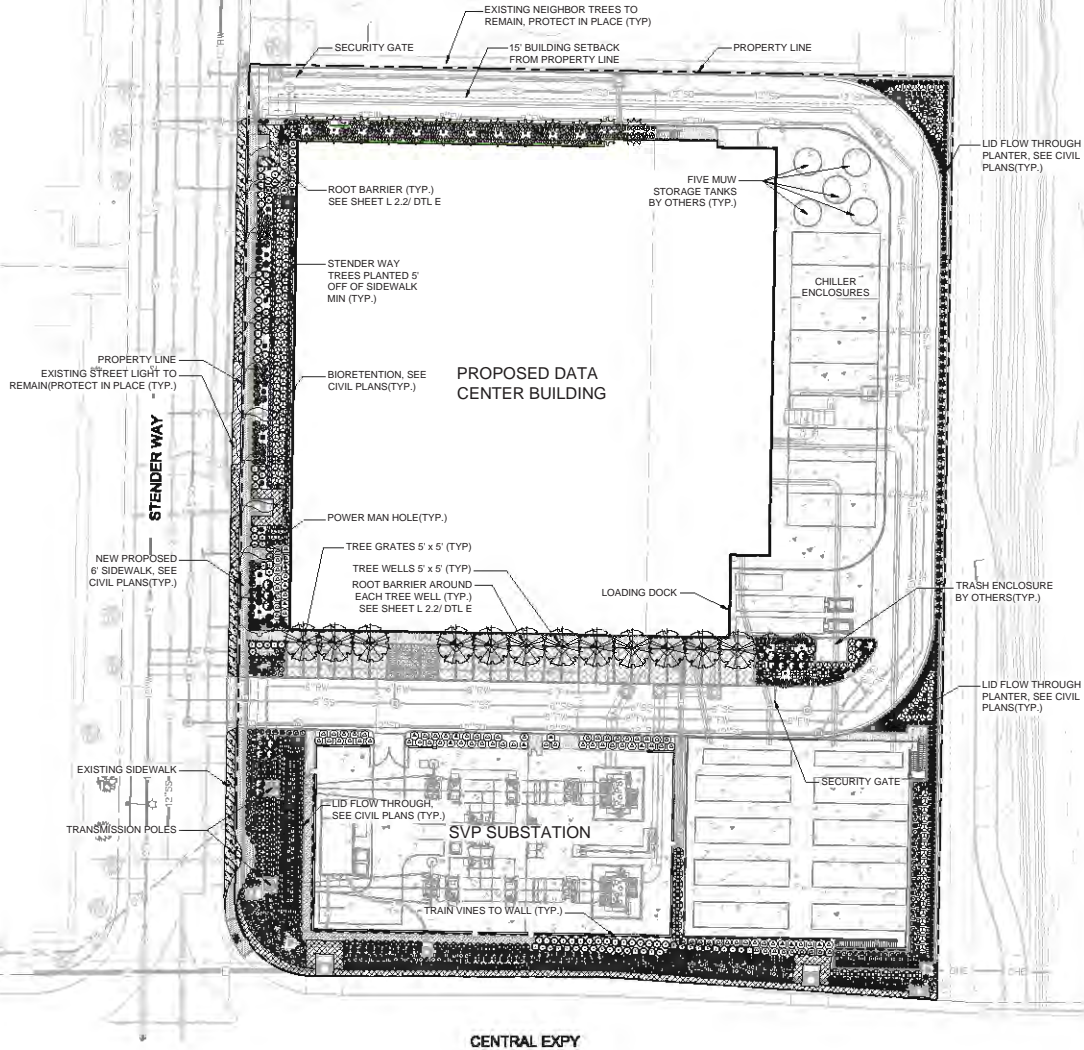

CENTRAL EXPY

**PLANT LEGEND** (SEE SHEET L2.1 FOR FULL PLANT SCHEDULE)

TREES	CODE	BOTANICAL / COMMON NAME
	AG	APROCARPUS GRACILIOR / AFRICAN FERN FINE
	CO	CERES OCCIDENTALIS / WESTERN REDBUD STANDARD
	CI	OLESTIA TRICANTHOS BURGESS / THORNLESS HONEYLOCUST
	LH	LALRUS NOBILIS 'SARATOGA' / SWEET BAY
	UA	ULMUS PARVIFOLIA 'ALLEE' / ALLEE LACEBARK ELM
SHRUBS	CODE	BOTANICAL / COMMON NAME
	BG	BOUTELOUA GRACILE / BLUE GRAMA GRASS
	CT	CAEXEY TUMULUCOLA / BERNALDI SEDGE
	CR	CHONENOPETALUM TECTORIUM / CAPE RUSH
	FC	FERTUCA CALIFORNICA / CALIFORNIA FESCUE
	HB	HELIOTROCHON BEMPERVENSIS / BLUE OAT GRASS
	JP	JUNCUS PATENS / CALIFORNIA GRAY RUSH
	LC	LYMELUS CONDENSATUS 'CANYON PRINCE' / NATIVE BLUE RYE
	MB	MISCANTHUS BINEBIS 'ADAGIO' / ADAGIO BULALIA GRASS
	MC	MUHLENBERGIA CAPILLARIS / PINE MUHLY GRASS
	MD	MUHLENBERGIA DUBIA / PINE MUHLY
	ML	MUHLENBERGIA LINDSEYI / LINDSEYI'S MUHLY
	MR	MUHLENBERGIA ROSENS / DEER GRASS
	PB	PHORMIUM TENAX 'JACK SPRATT' / JACK SPRATT FLAX
	PD	PHORMIUM X 'DARK DELIGHT' / PURPLE FLAX
	PGB	PYRAGANTHA COCCINEA / SCARLET PYRAGANTHA
	RE	RHAMNUS CALIFORNICA 'EVE CASE' / CALIFORNIA COFFEEBERRY
	SN	STIPA ARUNDINACEA / NEW ZEALAND WIND GRASS
	WF	WESTRINGIA FRUTICOSA / COAST ROSBAYRY
GROUND COVER	CODE	BOTANICAL / COMMON NAME
	AM	ARGENTOSTAPHYLOS X 'EMERALD CARPET' / EMERALD CARPET MANZANITA
	CM	CARSSA MACROCARPA 'PROSTRATA' / PROSTRATE NATAL PLUM
	MP	MYOPORUM PARVIFOLIUM 'PUTAH CREEK' / PUTAH CREEK MYOPORUM
MATERIALS	CODE	COMMON NAME
	RB	ROOT BARRIER
	RC	ROCK DOUBLE - 18" CRUSHED ROCK
	TG	TREE GRATE - 60" x 60" SIZES

**NOTE TO REVIEWER**

- FOR INFORMATION REGARDING TREES TO BE REMOVED, REFER TO TREE DISPOSITION PLANS ON SHEETS L1.0 & L1.1
- FOR FULL PLANT SCHEDULE AND ADDITIONAL INFORMATION ON PROPOSED PLANT MATERIAL, SEE SHEET L2.1
- ALL PROPOSED TREES SHALL MEET THE REQUIRED SPACING REQUIREMENTS FROM ELECTRICAL CONDUIT AS SPECIFIED BY SD1235 TREE PLANTING REQUIREMENTS.
- ALL PROPOSED STORMWATER TREATMENT LANDSCAPE SHALL BE FROM THE APPROVED PLANT SPECIES LIST IN APPENDIX D OF SCUBRPP C-3 STORMWATER HANDBOOK.

TREE DISPOSITION / REPLACEMENT	
EXISTING OFFSITE SV9 NEIGHBOR TREES TO REMAIN	9
EXISTING TREES ONSITE TO BE REMOVED	39
36" BOX SIZE REPLACEMENT TREES	39
ADDITIONAL TREE MITIGATION REQUIRED	0(24" BOX) OR 0(36" BOX)

**ALERT TO CONTRACTOR:**

- WHEN PERFORMING GRADING OPERATIONS DURING PERIODS OF WET WEATHER, PROVIDE ADEQUATE DEWATERING, DRAINAGE AND GROUND WATER MANAGEMENT TO CONTROL MOISTURE OF SOILS. REFER TO MASTER SITE SPECIFICATIONS.
- ALL GENERAL CONTRACTOR WORK TO BE COMPLETED (EARTHWORK, FINAL UTILITIES, AND FINAL GRADING) BY THE MILESTONE DATE IN PROJECT DOCUMENTS.

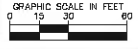

**Kimley-Horn**  
 • 4020 KIMLEY-HORN AND ASSOCIATES, INC.  
 16 SOUTH ALMADEN BLVD, SUITE 1250  
 SAN JOSE, CA 95113  
 PHONE: 669-800-4130 FAX: 714-938-9488  
 WWW.KIMLEY-HORN.COM



IT IS A CONDITION OF CONTRACT FOR THE USER OF THESE PLANS TO ACT AS A LICENSED ARCHITECT UNDER THE SUPERVISION OF A LICENSED ARCHITECT TO SIGN AND SEAL THESE PLANS IN ANY WAY.

**CORESITE - SV9**  
 2505-2509 STENDER WAY,  
 SANTA CLARA, CA 95054

JOB NO.: 197252801  
 PRINT DATE: 05/28/2020  
 DESIGNED BY: MT  
 CHECKED BY: MM  
 SET ISSUED:  
 10/28/2019 PCC SUBMITTAL 1  
 02/12/2020 PCC SUBMITTAL 2  
 02/24/2020 SCHEMATIC DESIGN  
 05/28/2020 PCC SUBMITTAL 3

SHEET NAME:  
**LANDSCAPE PLAN**  
 SHEET NO.: **L2.0**



**Clearances Under and Near Transmission Overhead Lines**

**Wire Zone Transmission**

The Wire Zone under Transmission lines extends 10 feet out from conductors. Maximum vegetation height in this zone is 3 feet. In general, tree planting within the "wire zone" is not recommended by SVT, and should be avoided. Most SVT assessments do not allow planting of trees within the clearance area. If plantings are selected, it is important to recognize that removal may become necessary to ensure safe and reliable electric service, and also maintain compliance with Federal and State Laws.

**Border Zone Transmission**

The Border Zone extends 40 feet out from the Wire Zone (see above). Maximum vegetation height in this zone is 10 feet. Tree planting selections within the "border zone" should recognize proximity of utilities in relation to tree height, root structure and canopy width upon maturity. If tree plantings are selected, it is important to recognize that removal may eventually become necessary to ensure safe and reliable electric service, and also maintain compliance with Federal and State Laws. Planting trees that will become tall enough to target or "fall into" the power lines should always be avoided in this zone.

**Outer Zone Transmission**

The Outer Zone begins 50 feet out from conductors. There is no stated maximum tree height in this zone, but failure of trees with the ability to reach energized conductors (utility wires) is of primary concern. Annual pruning or removal may be required to ensure safe and reliable electric service, and also maintain compliance with Federal and State Laws.

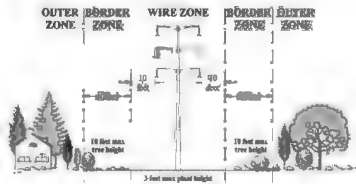
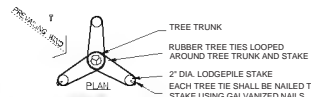

Figure 2: Tree Zones Near Transmission Lines

Rev. 1: Issue	Tree Clearances From Overhead Electric Lines	Drawn by: AA
Approval: 09/09/2016		Sheet 7 of 8
		081230
		Rev. 1

**A TREE CLEARANCES FROM OVERHEAD ELECTRIC LINES**



- NOTES:**
1. REFERENCE PLANTING SPECIFICATIONS/ SPECIAL PROVISIONS FOR ADDITIONAL INFORMATION.
  2. TRIPLE STAKE ALL TREES #36" BOX SIZE AND LARGER.
  3. LOCATE ALL STAKES OUTSIDE OF ROOTBALL. DO NOT DRIVE STAKES INTO ROOTBALL. STAKES MUST BE DRIVEN MIN. 24" INTO NATIVE SOIL AT BOTTOM OF PLANTING PIT.
  4. REMOVE ANYTHING (IE. BURLAP, WIRES, STRAPS, ETC.) THAT COULD GIRDLE TREE OR RESTRICT TREE GROWTH.

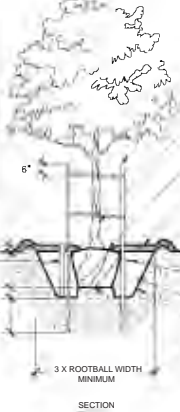

- 2" DIA. LODGEPOLE STAKES AND 6 RUBBER TIES. TOP TREE TIES SHALL BE 6" ABOVE BENDING MOMENT OF TREE. TIES SHOULD PROVIDE FLEXIBILITY OF TRUNK BUT NOT ALLOW RUBBING OF TRUNK AGAINST STAKE. CUT STAKE OFF 6" ABOVE TIES.
- TRUNK/ROOTBALL TO BE CENTERED AND PLUMB/LEVEL IN PLANTING PIT
- 6" DIA. CLEAR OF MULCH AT TRUNK FLARE
- 3" MULCH LAYER
- 4" HIGH BERM, FIRMLY COMPACTED
- FINISHED GRADE.
- UNDISTURBED NATIVE SOIL
- FERTILIZER TABLETS (MAX 3" DEEP)
- PREPARED BACKFILL
- SCARIFY BOTTOM AND SIDES OF PLANTING PIT
- SET ROOTBALL ON UNDISTURBED STABLE SUBSOIL SO THAT TOP OF ROOTBALL IS 1" ABOVE FINISHED GRADE AND TO PREVENT SETTLING.

**F 36" AND LARGER BOX TREE PLANTING**

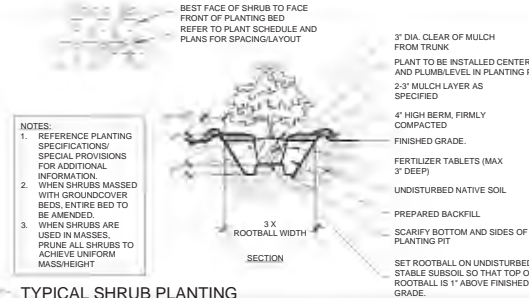

**B TYPICAL SHRUB PLANTING**

- NOTES:**
1. REFERENCE PLANTING SPECIFICATIONS/ SPECIAL PROVISIONS FOR ADDITIONAL INFORMATION.
  2. WHEN SHRUBS MASSED WITH GROUNDCOVER BEDS, ENTIRE BED TO BE AMENDED.
  3. WHEN SHRUBS ARE USED IN MASSSES, PRUNE ALL SHRUBS TO ACHIEVE UNIFORM MASS/HEIGHT

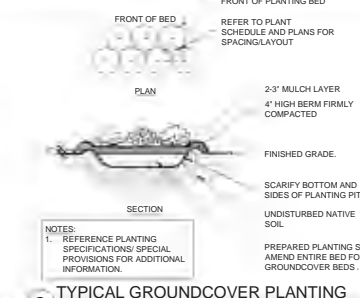

**C TYPICAL GROUNDCOVER PLANTING**

- NOTES:**
1. REFERENCE PLANTING SPECIFICATIONS/ SPECIAL PROVISIONS FOR ADDITIONAL INFORMATION.

- NOTES:**
- SPECIFIED TREE ROOT BARRIERS ARE A MECHANICAL BARRIER AND ROOT DEFLECTOR TO PREVENT TREE ROOTS FROM DAMAGING ADJACENT PAVING/ HARDSCAPE ELEMENTS. ASSEMBLED IN 2' LONG MODULES OR FOR LINEAR APPLICATIONS DIRECTLY BESIDE AN ADJACENT HARDSCAPE AREA TO ONE SIDE OF THE TREE'S LINEAR PLANTING STYLE.

- MATERIALS:**
1. THE CONTRACTOR SHALL FURNISH AND INSTALL TREE ROOT BARRIERS AS SPECIFIED. THE TREE ROOT BARRIERS SHALL BE PRODUCT # UB 24-24-AS MANUFACTURED BY EDEE PACT PARTNERS, LP, 208 WASHINGTON STREET, SAN FRANCISCO, CA 94111 (88-458-7888) OR APPROVED EQUAL. THE BARRIER SHALL BE BLACK, INJECTION MOLDED PANELS, OF 0.085" WALL THICKNESS IN MODULES 24" LONG BY 24" DEEP, MANUFACTURED WITH A MINIMUM 50% POST CONSUMER RECYCLED POLYPROPYLENE PLASTIC WITH ADDED ULTRAVIOLET INHIBITORS, RECYCLABLE.

- CONSTRUCTION AND INSTALLATION:**
1. THE CONTRACTOR SHALL INSTALL THE TREE ROOT BARRIERS WITH THE NUMBER OF PANELS AND IN THE MANNER SHOWN ON THE DRAWINGS. THE VERTICAL ROOT DEFLECTING RIBS SHALL BE FACING INWARDS TO THE ROOT BALL AND THE TOP OF THE DOUBLE EDGE SHALL BE 1/2" ABOVE GRADE. EACH OF THE REQUIRED NUMBER OF PANELS SHALL BE CONNECTED EITHER TO FORM A CIRCLE AROUND THE ROOT BALL OR BE JOINED IN A LINEAR FASHION AND PLACED ALONG THE ADJACENT HARDSCAPE.
  - 2.

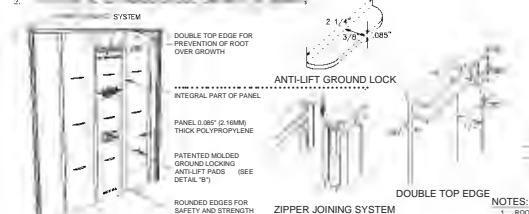

**E ROOT TREE BARRIER**

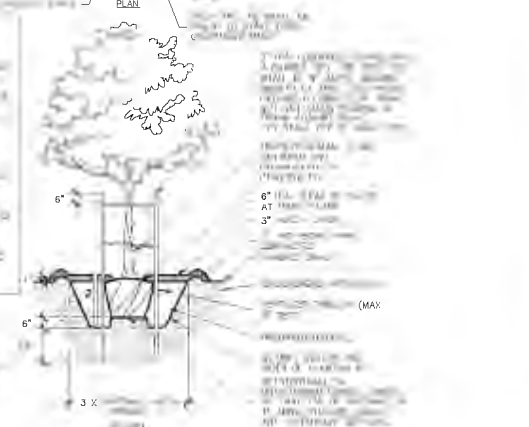
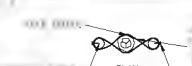

**G TYPICAL TREE PLANTING (UP TO 24" BOX)**

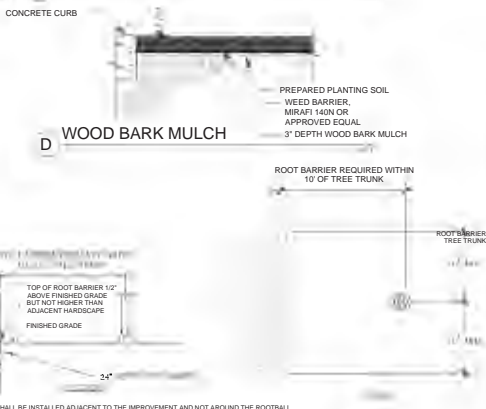

**D WOOD BARK MULCH**

- NOTES:**
1. ROOT BARRIER SHALL BE INSTALLED ADJACENT TO THE IMPROVEMENT AND NOT AROUND THE ROOTBALL.
  2. ROOT BARRIER REQUIRED WHEN TREE TRUNK IS WITHIN 10' OF HARDSCAPE, WALLS, BUILDINGS, BROWN DITCHES, OR OTHER IMPROVEMENTS

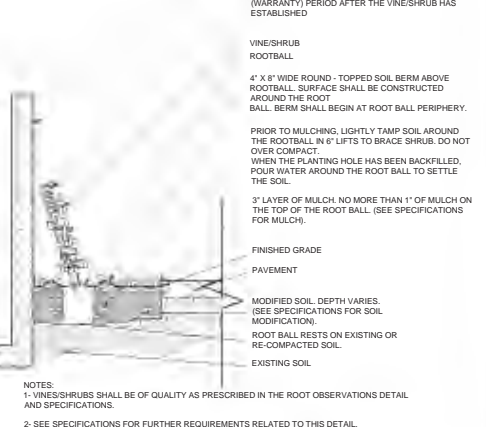

**H VINE/SCREENING SHRUB PLANTING**

- NOTES:**
1. VINES/SHRUBS SHALL BE OF QUALITY AS PRESCRIBED IN THE ROOT OBSERVATIONS DETAIL AND SPECIFICATIONS.
  2. SEE SPECIFICATIONS FOR FURTHER REQUIREMENTS RELATED TO THIS DETAIL.

**Kimley-Horn**

4020 KIMLEY-HORN AND ASSOCIATES, INC.  
 10 SOUTH ALMADEN BLVD, SUITE 1250  
 SAN JOSE, CA 95113  
 PHONE: 669-900-4130 FAX: 714-938-9488  
 WWW.KIMLEY-HORN.COM

LANDSCAPE ARCHITECT OF RECORD SEAL

IT IS HEREBY CERTIFIED THAT THE DESIGNER HAS ACTED UNDER THE SUPERVISION OF A LICENSED ARCHITECT TO THE BEST OF HIS KNOWLEDGE AND BELIEF.

**CORESITE - SV9**

2605-2609 STENDER WAY,  
 SANTA CLARA, CA 95054

JOB NO.:	197252001
PRINT DATE:	05/28/2020
DESIGNED BY:	MT
CHECKED BY:	MM
SET ISSUED:	
10/28/2019	PCC SUBMITTAL 1
02/12/2020	PCC SUBMITTAL 2
02/24/2020	SCHEMATIC DESIGN
05/28/2020	PCC SUBMITTAL 3

**LANDSCAPE DETAILS**

SHEET NO. **L.2.2**

10/28/2019 5:29 PM  
 DRAWING(S) TO: LANDSCAPE  
 PLOT: WAX - L261 (1/17/2020)

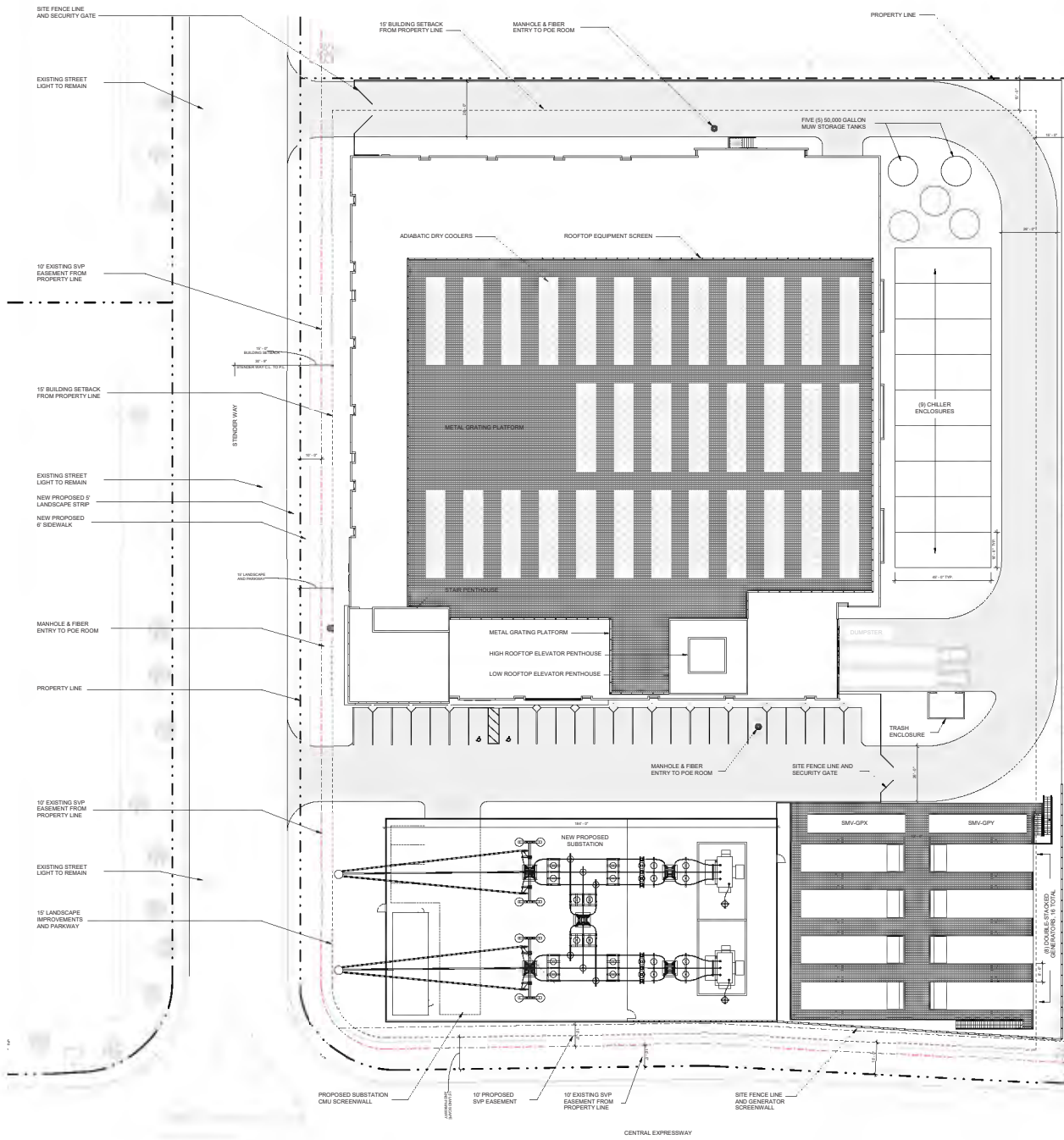

1 OVERALL SITE PLAN  
1" = 20'-0"



CORGAN  
401 N. Houston St  
Dallas, TX 75202  
T: 214-748-2000

ISSUES

1	09.16.2019	PCC SUBMISSION
2	10.28.2019	PCC SUBMISSION #1
3	01.18.2020	PCC SUBMISSION #2
4	05.28.2020	PCC SUBMISSION #3
5		
6		
7		
8		
9		
10		

REVISIONS

This document is incomplete and may not be used for regulatory approval, permit or construction.

Date of issue: **08.26.2020**

**CORESITE SV9**  
PCC SUBMISSION  
2905 STENDER WAY  
SANTA CLARA, CA 95054

KEYPLAN

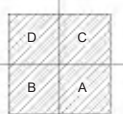

SITE PLAN

JOB 19199.0000  
DATE 09.04.2019  
SHEET

EX - 01







FLOOR PLAN - LEVEL FOUR  
 3/32" = 1'-0"

WALLS &  
 PARTITIONS  
 TO FLOOR ROOM

STENDER WAY

1/EX-06

01'-00"



WALLS &  
 PARTITIONS  
 TO FLOOR ROOM

FIRE RESISTANT  
 M/W STORAGE PARTS

- ISSUES
- 1. 08/26/2019 PCC SUBMISSION #1
  - 2. 08/26/2019 PCC SUBMISSION #1
  - 3. 08/26/2019 PCC SUBMISSION #1
  - 4. 08/26/2019 PCC SUBMISSION #1
  - 5. 08/26/2019 PCC SUBMISSION #1
  - 6. 08/26/2019 PCC SUBMISSION #1
  - 7. 08/26/2019 PCC SUBMISSION #1
  - 8. 08/26/2019 PCC SUBMISSION #1
  - 9. 08/26/2019 PCC SUBMISSION #1
  - 10. 08/26/2019 PCC SUBMISSION #1

REVISIONS

This document is incomplete and may not be used for regulatory approval, permit or construction.  
 Date of Issue: **08/26/2020**

PCC SUBMISSION  
 2905 STENDER WAY  
 SANTA CLARA, CA 95054

KEY PLAN

- D C
- B A

FLOOR PLAN -  
 LEVEL FOUR

JOB 19199.0000  
 DATE 09.16.2019  
 SHEET EX - 05

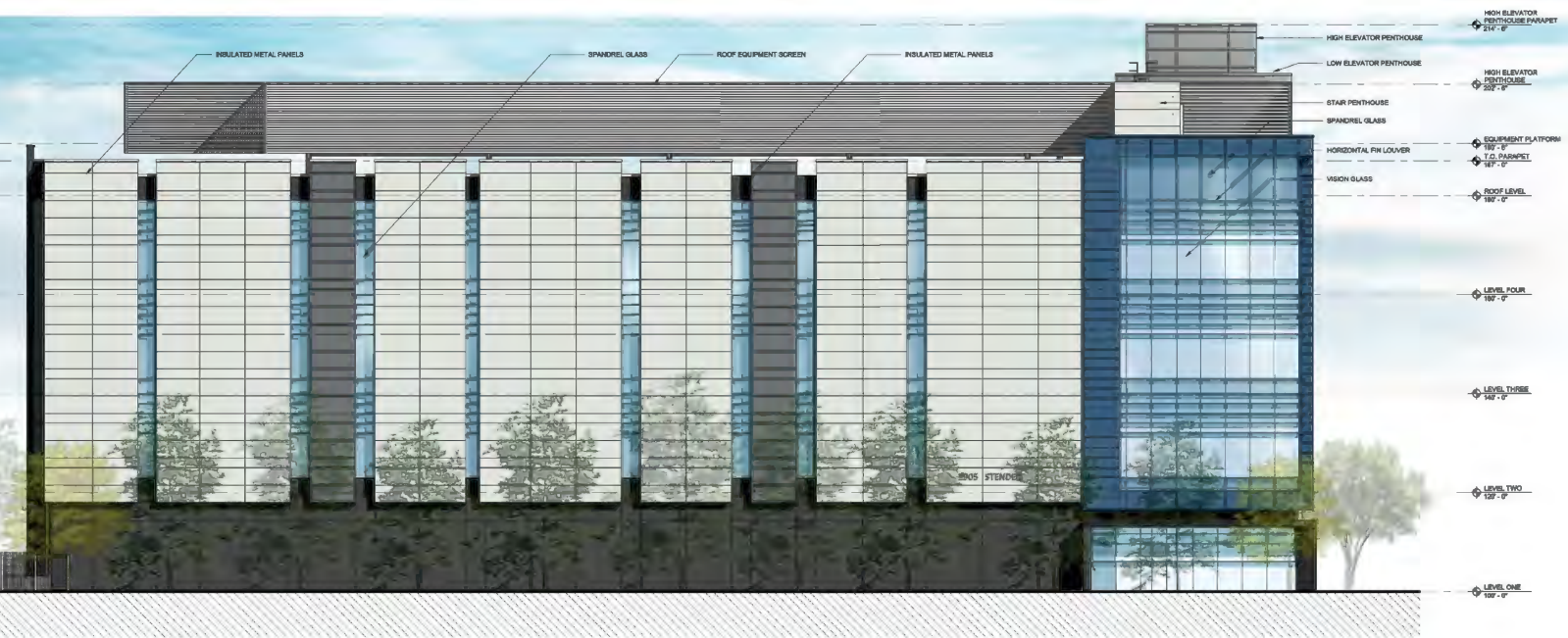

**ISSUES**

1	06.16.2019	PCC SUBMISSION
2	10.28.2019	PCC SUBMISSION #1
3	02.16.2020	PCC SUBMISSION #2
4	05.28.2020	PCC SUBMISSION #3
5		
6		
7		
8		
9		
10		

**REVISIONS**

1		
2		
3		
4		
5		
6		
7		
8		
9		
10		

This document is incomplete and may not be used for regulatory approval, permit or construction.

Date of issue:  
05.28.2020

**CORESITE SV9**  
PCC SUBMISSION  
2905 STENDER WAY  
SANTA CLARA, CA 95054

**EXTERIOR ELEVATIONS**

JOB 19199.0000  
DATE 09.16.2019  
SHEET  
**EX - 07**

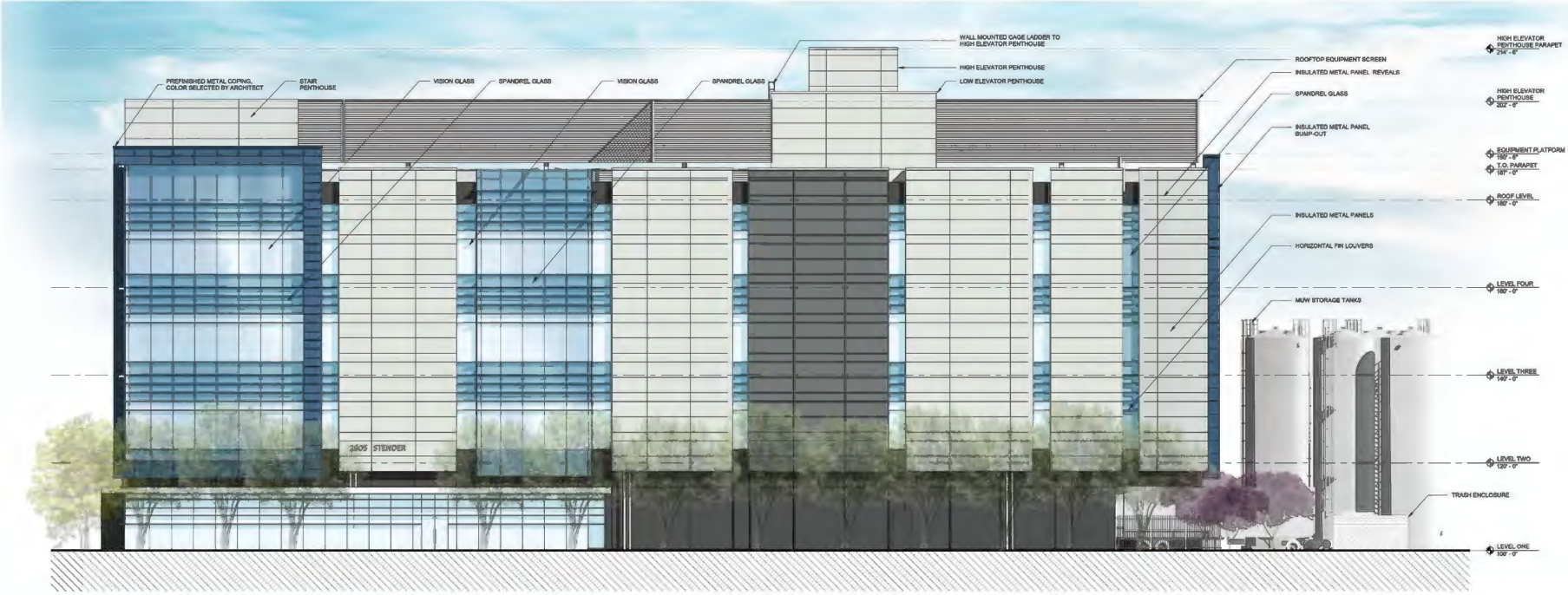

2 SOUTH ELEVATION  
1" = 10'-0"

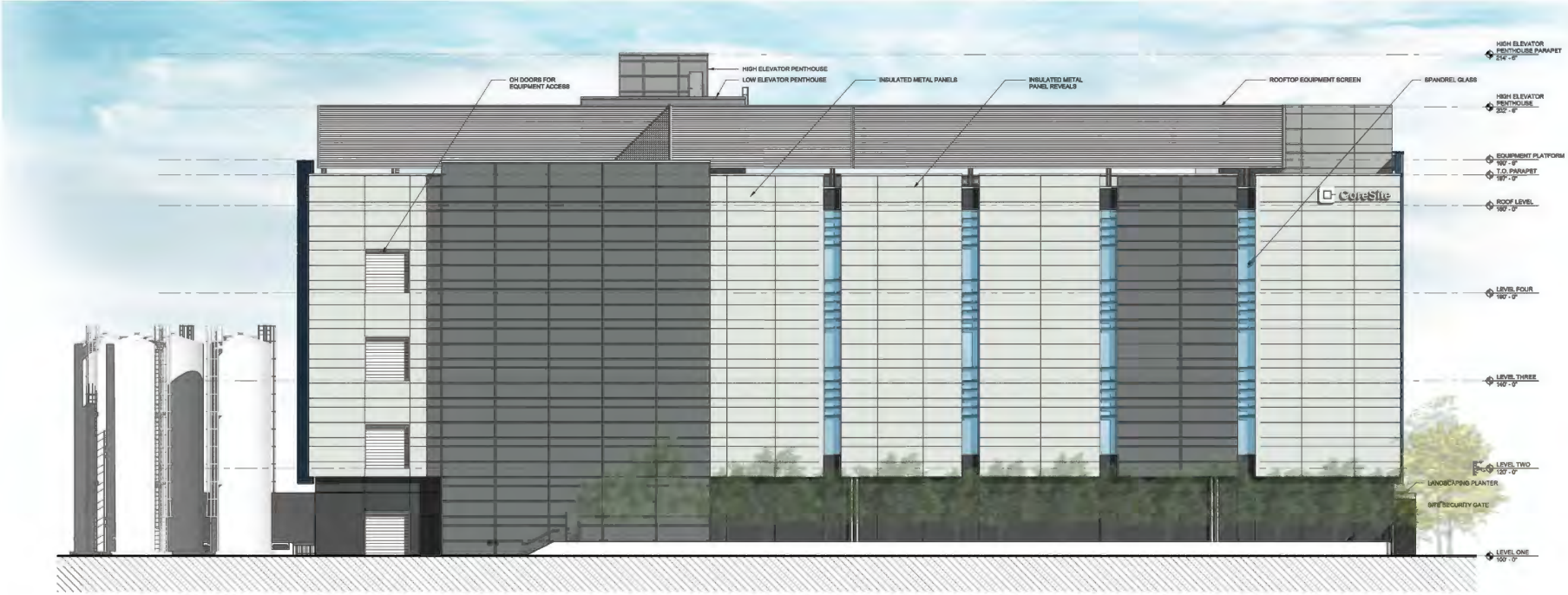

1 NORTH ELEVATION  
1" = 10'-0"

5/27/2020 1:23:31 PM EX - 07 EXTERIOR ELEVATIONS





